



Part No. MMBB0181801 (1.1) 

Printed in Korea

U8290 User Guide



T-Mobile



U8290 User Guide



 0889

This document is the User's Guide for the LG U8290 3G Video Mobile Phone. All rights for this document are reserved by LG Electronics. Copying, modifying and distributing this document without the consent of LG Electronics are prohibited.

U8290 User Guide

English

This document is the User's Guide for the LG U8290 3G Video Mobile Phone. All rights for this document are reserved by LG Electronics. Copying, modifying and distributing this document without the consent of LG Electronics are prohibited.

Disposal of your old appliance



1. When this crossed-out wheeled bin symbol is attached to a product it means the product is covered by the European Directive 2002/96/EC.
2. All electrical and electronic products should be disposed of separately from the municipal waste stream via designated collection facilities appointed by the government or the local authorities.
3. The correct disposal of your old appliance will help prevent potential negative consequences for the environment and human health.
4. For more detailed information about disposal of your old appliance, please contact your city office, waste disposal service or the shop where you purchased the product.

Table of Contents

Guidelines	6	1. Profiles	31
Installing the SIM card	10	General	31
Charging the Battery	12	Silent	31
Disconnecting the charger	13	Outdoor	31
How to use a TransFlash (TFlash) memory card	14	Vibrate only	31
Part of the Phone	16	Headset	31
Key functions	17	Car	31
Getting Started	18	User defined 1	31
Display information	20	User defined 2	31
General Functions	23	2. My Media	33
Special Functions	28	2.1 Photos	33
Main Menu	29	2.2 Pictures	33
		2.3 Sounds	36
		2.4 Music	38

2.5 Games & more	39	4.3 E-mail inbox	62
2.6 Videos	44	4.4 Drafts	63
2.7 Bluetooth data	45	4.5 Outbox	64
2.8 External memory	46	4.6 Sent	64
3. Call register	48	4.7 Voice mail	65
3.1 Missed calls	48	4.8 Templates	65
3.2 Received calls	48	4.9 Settings	66
3.3 Dialed calls	48	5. t-zones	71
3.4 All calls	48	How to access t-zones	71
3.5 Call durations	48	6. Contacts	72
4. Messages	50	6.1 Add new	72
4.1 New message	50	6.2 Search	72
4.2 Inbox	61	6.3 Speed dials	72

Table of Contents

6.4 Group manager	72	8. Camera	83
6.5 Own number	72	8.1 Take photo	83
6.6 Settings	73	8.2 Take video	84
7. Organiser	74	8.3 Memory status	85
7.1 Alarm clock	74	9. Settings	86
7.2 Calendar	74	9.1 Profiles (for SAT SIM)	86
7.3 To do	77	9.2 Date & Time	86
7.4 Memo	77	9.3 Favourites	86
7.5 Date counter	78	9.4 Phone settings	87
7.6 Voice recorder	78	9.5 Call settings	88
7.7 Calculator	79	9.6 Connectivity	93
7.8 Unit converter	80	9.7 Security	100
7.9 World time	81	9.8 Memory status	104
7.* Stop watch	82	9.9 Handset info.	105

9.* Internet	105
9.# Reset settings	109
Troubleshooting	110
Accessories	112
Index	114

Guidelines

Read these simple guidelines. Breaking the rules may be dangerous or illegal. Further detailed information is given in this manual.

Exposure to radio frequency energy

Radio wave exposure and Specific Absorption Rate (SAR) information

This mobile phone model U8290 has been designed to comply with applicable safety requirement for exposure to radio waves. This requirement is based on scientific guidelines that include safety margins designed to assure this safety of all persons, regardless of age and health.

- The radio wave exposure guidelines employ a unit of measurement known as the Specific Absorption Rate, or SAR.

Tests for SAR are conducted using standardized method with the phone transmitting at its highest certified power level in all used frequency bands.

- While there may be differences between the SAR levels of various LG phone models, they are all designed to meet the relevant guidelines for exposure to radio waves.

- The SAR limit recommended by the international Commission on Non-Ionizing Radiation Protection (ICNIRP), which is 2W/kg averaged over ten (10) gram of tissue.
- The highest SAR value for this model phone tested by DASY3 for use at the ear is 0.658 W/kg (10g).
- SAR data information for residents in countries/regions that have adopted the SAR limit recommended by the Institute of Electrical and Electronics Engineers (IEEE), which is 1.6 W/kg averaged over one (1) gram of tissue (for example USA, Canada, Australia and Taiwan).

Product care and maintenance

Warning: Use only batteries, charger and accessories approved for use with this particular phone model. The use of any other types may invalidate any approval or warranty applying to the phone, and may be dangerous.

- Do not disassemble this unit. Take it to a qualified service technician when repair work is required.
- Keep away from electrical appliances such as a TV, radio or personal computer.

- The unit should be kept away from heat sources such as radiators or cookers.
- Do not drop.
- Do not subject this unit to mechanical vibration or shock.
- The coating of the phone may be damaged if covered with wrap or vinyl wrapper.
- Use dry cloth to clean the exterior of the unit. (Do not use solvent such as benzene, thinner or alcohol.)
- Do not subject this unit to excessive smoke or dust.
- Do not keep the phone next to credit cards or transport tickets; it can affect the information on the magnetic strips.
- Do not tap the screen with a sharp object; otherwise, it may damage the phone.
- Do not expose the phone to liquid or moisture.
- Use the accessories like an earphone cautiously. Do not touch the antenna unnecessarily.
- Please remove the data cable before power on the handset.

Efficient phone operation

To enjoy optimum performance with minimum power consumption please:

- Hold the phone as you speak to any other telephone. While speaking directly into the microphone, angle the antenna in a direction up and over your shoulder.
- Do not hold the antenna when the phone is in use. If you hold it, it can affect call quality, it also may cause the phone to operate as a higher power level that needed and shorten talk and standby times.

Electronics devices

All mobile phones may get interference, which could affect performance.

- Do not use your mobile phone near medical equipment without requesting permission. Avoid placing the phone over the pacemaker, i.e. in your breast pocket.
- Some hearing aids might be disturbed by mobile phones.
- Minor interference may affect TVs, radios, PCs, etc.

Road safety

Check the laws and regulations on the use of mobile phones in the areas when you drive.

- Do not use a hand-held phone while driving.
- Give full attention to driving.
- Use a hands-free kit, if available.
- Pull off the road and park before making or answering a call if driving conditions so require.
- RF energy may affect some electronic systems in your motor vehicle such as car stereos and safety equipment.
- If your vehicle is equipped with an air bag, do not obstruct with installed or portable wireless equipment. It can cause serious injury due to improper performance.

Blasting area

Do not use the phone where blasting is in progress. Observe restrictions, and follow any regulations or rules.

Potentially explosive atmospheres

- Do not use the phone at a refuelling point. Don't use near fuel or chemicals.
- Do not transport or store flammable gas, liquid, or explosives in the compartment of your vehicle, which contains your mobile phone and accessories.

In aircraft

Wireless devices can cause interference in aircraft.

- Turn off your mobile phone before boarding any aircraft.
- Do not use it on the ground without crew permission.

Children

Keep the phone in a safe place out of small children's reach. It includes small parts which if detached may cause a choking hazard.

Emergency calls

Emergency calls may not be available under all cellular networks. Therefore, you should never depend solely on your mobile phone for emergency calls. Check with your local service provider.

Battery information and care

- You do not need to completely discharge the battery before recharging. Unlike other battery systems, there is no memory effect that could compromise the battery's performance.
- Use only LG batteries and chargers. LG chargers are designed to maximize the battery life.
- Do not disassemble or short-circuit the battery pack.
- Keep the metal contacts of the battery pack clean.

- Replace the battery when it no longer provides acceptable performance. The battery pack may be recharged hundreds of times until it needs replacing.
- Recharge the battery if it has not been used for a long time to maximize usability.
- Do not expose the battery charger to direct sunlight or use it in high humidity, such as the bathroom.
- Do not leave the battery in hot or cold places, this may deteriorate the battery performance.

Installing the SIM card

Your SIM card contains your phone number, service details and contacts and must be inserted into your handset.

If your SIM card is removed then your handset becomes unusable (except emergency calls) until a valid one is inserted. Always disconnect the charger and other accessories from your handset before inserting and removing your SIM card.



Notice

Before installing always make sure that the phone is switched off and remove the battery.

The metal contact of the SIM card can be easily damaged by scratches. Pay special attention to the SIM card while handling and installing. Follow the instructions supplied with the SIM card.

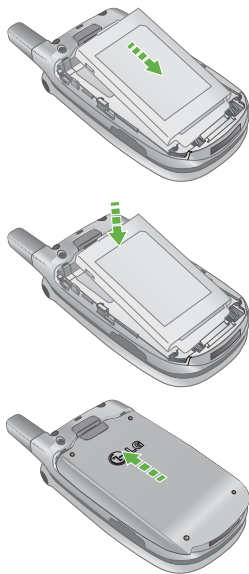

Charging the Battery

To connect the travel adapter to the phone, you must first install the battery.

1. With the arrow facing you as shown in the diagram push the plug on the battery adapter into the socket on the bottom of the phone until it clicks into place.

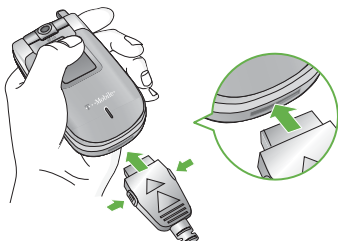

2. Connect the other end of the travel adapter to the mains socket.
Use only the charger included in the box.

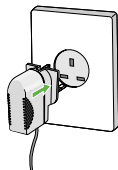

ⓘ Warning

Do not force the connector as this may damage the phone and/or the travel adapter.

Please notice the unusual Start time that can take up to 35 seconds at a first power on or when removing the battery.

Disconnect the travel adapter from the phone by pressing its side buttons as shown in the diagram.

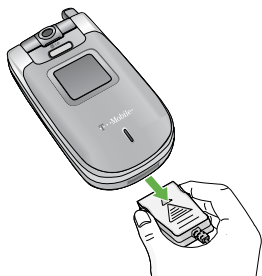

Note

- Ensure the battery is fully charged before using the phone.
- Do not remove your battery or the SIM card while charging.
- The moving bars of the battery icon will stop after charging is complete.
- If the battery is completely discharged, the charge could take some minutes before starting.

Note

- If the battery does not charge,
- switch the phone off.
 - ensure the battery is correctly fit.

How to use a TransFlash (TFlash) memory card

The phone has 20MB of internal memory, which can be expanded using a TransFlash (TFlash) memory card. The TransFlash product is an ultra small, semi-removable flash memory module especially designed for mobile phones. The phone can support TransFlash memory cards of a capacity of at least 256MB.



<Transflash memory card>

<How to insert a TransFlash memory card>

1. Power off the phone. Inserting or removing the TransFlash when the phone is on may damage the files stored in the memory card.
2. Lift the plastic cover which protects the TransFlash slot.



3. Insert the memory card in the slot. The gold contacts must be kept on the back of the TransFlash. Don't push the TransFlash too much. If it cannot enter easily in the slot, you may be trying to insert it in the wrong way or there could be a foreign object in the slot.



4. Once inserted, push the memory card until you hear a “click”, meaning that the TransFlash has been correctly blocked.



5. Close the slot plastic protection.
6. To remove the memory card, power off the phone, open the slot protection and push the TransFlash to unlock it. Carefully extract the memory card.

Attention:

- Avoid using the Flash Memory Card when the battery is low.
- When writing to the card, wait for the operation to complete before removing the card.
- The card is designed to fit easily into the system one way only.

- Do not bend the card or force it into the slot.
- Do not insert any other kind of memory cards different from TransFlash.

For more information on the TransFlash, please refer to the instructions manual of the memory card.

Parts of the Phone

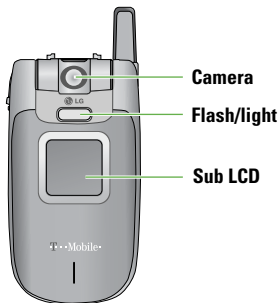

Sides of handset

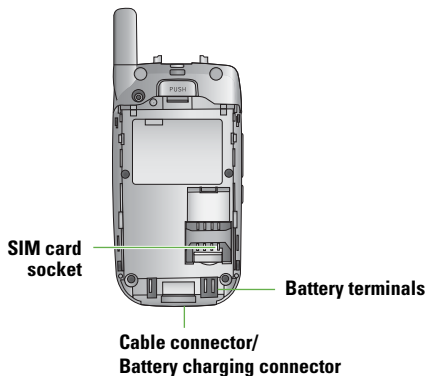
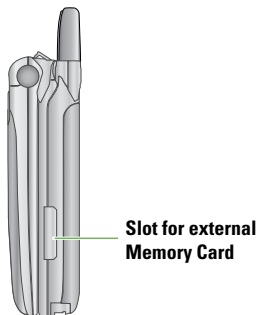

Battery cover

Note

Connect jack to fit the shape of terminal. Otherwise, product can be damaged.

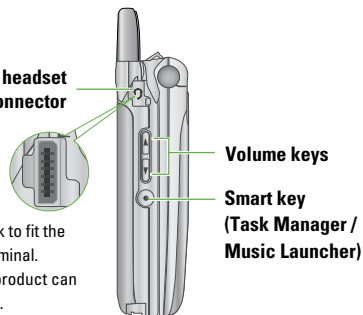

Battery

Key functions



Getting Started

Turning your handset on

Ensure that your SIM card is in your handset and the battery is charged.

Press and hold the  key until power is on.

Enter the SIM PIN code that was supplied with your SIM card if PIN code setting is on.

After a few seconds you will be registered on the network.

Turning your handset off

Press and hold the  key until power is off.

There may be a few seconds delay while the handset powers down.

Do not re-power the handset during this time.

Access Codes

You can use the access codes described in this section to avoid unauthorized use of your phone. The access codes (except PUK and PUK2 codes) can be changed by using the Change codes feature [Menu 9.7.5].

PIN code (4 to 8 digits)

The PIN (Personal Identification Number) code protects your SIM card against unauthorized use. The PIN code is usually supplied with the SIM card. When the PIN Code Request is set to Enable, your phone will request the PIN code every time it is switched on. When the PIN Code Request is set to Disable, your phone connects to the network directly without the PIN code.

PIN2 code (4 to 8 digits)

The PIN2 code, supplied with some SIM cards, is required to access functions such as Fixed Dial Number. These functions are only available if supported by your SIM card.

PUK code (4 to 8 digits)

The PUK (PIN Unblocking Key) code is required to unlock a blocked PIN code. The PUK code may be supplied with the SIM card. If not, contact your network operator's customer service for the code. If you lose the code, contact your network operator's customer service.

PUK2 code (4 to 8 digits)

The PUK2 code, supplied with some SIM cards, is required to unlock a blocked PIN2 code. If you lose the code, contact your network operator's customer service.

Security code (4 to 8 digits)

The security code protects the unauthorized use of your phone. The default security code is set to '0000' and the security code is required to delete all phone entries and to restore the handset to factory setting.

Display information

No SIM Idle Screen

This is the initial screen of the phone that appears when there is no SIM card installed in the phone, or the installed SIM card is invalid. In this screen, users can only make emergency calls, and turn the phone off. To turn off the phone, press and hold the End key for a few seconds.

Screen Structure

If there is no SIM card installed, an animation telling you to insert a SIM card appears. If the SIM card inserted into the phone is invalid, an animation telling you that the SIM card is locked appears.

Emergency Call Function

The Left soft key is represented by “SOS” on the screen. Press left softkey or key your emergency number using the number keys, and then press the OK key to make an emergency call.

Idle Screen

The idle screen appears when you have installed a proper SIM card and turned the phone on.

Screen Structure

Idle screen consists of the operator’s name, indicators, date, and time on a background image. You can change the wallpaper in the display settings menu.

Key Functions

The functions of the keys in the idle screen status are described below.

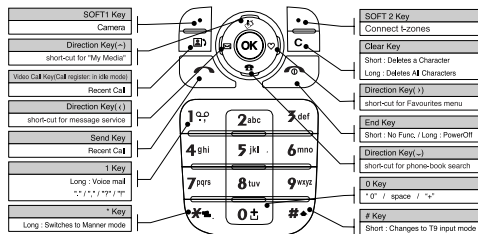

Numbering Screen

The numbering screen appears when a number key is pressed in the idle screen.

Screen Structure

The numbering screen consists of status indicators, dialled number, and soft menu. Status indicators are the same as that of the idle screen. You can change the size and colour of the dialling font in the display settings menu. You can make a call while dialling a phone number by pressing the Send or Video Call key.

Soft Key

You can use the soft keys for several functions while dialling a number. Using the left most soft key, you can save the current number to Contacts, you can send a message to the number, you can search for the number in Contacts and you can make a voice call/video call.

Handset Lock Screen

When the Handset Lock function is selected, you can only make an emergency call, release the lock, and turn off the phone in this screen. As always, you can turn the phone off by pressing and holding the End key for a few seconds.

Screen Structure

The screen structure of the Handset Lock screen is the same as that of the idle screen, except that the lock message appears instead of the idle screen.

Emergency Call Function

You can make an emergency call using the Left soft key. As with the No SIM Idle screen, only emergency numbers can be dialled.

Unlock Function

If you press the OK key, a popup screen appears asking you to input the Security code to unlock the phone. The Security code is configured by selecting **Settings** → **Security** → **Change password**. If you key in an incorrect Security Code, the phone will remain in Handset Lock status. If you key in the correct Security Code, the phone will be unlocked, and the idle screen will be displayed. If you have turned the phone off in the Handset Lock status, you will find the phone remains in Handset Lock status when you turn it on.

Barring Password

This service obstruct calling service in some condition. and this condition can be edited by user (9. Settings → 7. Security → 3. Call barring)

The barring password is required when you use the call barring function. The password is obtained from the your network operator's customer service when you subscribe to this function.

While this service is activated, caller will hear the information message that this call is not connected because of user's reason.

Making and Answering calls

Ensure you tell the other party before recording a voice call.

Making and Answering a video call

You can make a video call in 3G covered service area. If called user have a 3G video phone in 3G covered service area, the call will be established.

You can also answer a video call for video incoming call

To make/answer a video call, do the following.

1. Input the phone number using the keypad, or select the phone number from the calls made/received lists.

Note

To correct mistakes, press the **[C]** key briefly to delete the last number, or press and hold the **[C]** key to delete all numbers.



2. If you do not want to use the speakerphone, ensure you have the headset plugged in.
3. To start the video function, press **[V]**.

Note

You will be notified that you will need to close other applications to make the video call.

Note

The video call may take some time to connect. Please be patient. The connection time will also depend on how quickly the other party answers the call. While the video call is connecting, you will see your own images; after the other party has answered, their image will be displayed on screen.

4. Adjust the camera position if necessary.
5. Press the end key to finish the call, or close the handset.

Making a voice call

1. Enter the number including the full area code.
 - ▶ To delete a digit press the **[C]** key.
To delete all digits press and hold the **[C]** key.
2. Press the **[V]** key to make the call.

3. Press the  key to finish the call, or close the handset.



Note

To activate the speakerphone during a call, press and hold the  key for at least 2 secs.

Making a voice/video call from Contacts

It is easy to call anyone whose number you have stored in your Contacts.

Press the down navigation key to access the contacts list.

Scroll to your chosen contact. Press the  key to make a voice call, or  key to make a video call. Press the  key to finish the call.



Making International Calls

1. Press and hold the  key for the international prefix. The '+' character can be replaced with the international access code.
2. Enter the country code, area code, and the phone number.



3. Press the  key.

Adjusting the Volume



During a call, if you want to adjust the earpiece volume, use the side keys of the handset. In idle mode with the flip cover open, you can adjust the key volume using the side keys.

Answering a Call

When you receive a call, the phone rings and the flashing phone icon appears on the screen. If the caller can be identified, the caller's phone number (or name if stored in your Contacts) is displayed.

1. Open the flip and press the  key to answer an incoming call.
If the answer mode is set to Press any key, any key will answer a call except for the  key.

Note

- To reject an incoming call, press the  key or the right soft key twice.
 - If you set "Answer mode" as "Open flip" (Menu 9.5.8), you can answer the call simply by opening the flip.
2. End the call by closing the handset or pressing the  key.

Note

You can answer a call while using the Contacts or other menu features.

Signal Strength

If you are inside a building, being near a window may give you better reception. You can see the strength of your signal by the signal indicator see the strength () on your handset's display screen.







Entering Text

You can enter alphanumeric characters using the keypad.

For example, storing names in the Contacts, writing a message, creating a personal greeting or scheduling events in the calendar all require entering text. Following text input methods are available in the handset.



Changing the Text Input Mode

1. When you are in a field that allows characters to be entered, you will notice the text input mode indicator in the upper right corner of the display.

2. Short pressing the  key cycles between , ,  and . A long press changes mode to .

Using the T9 Mode

The T9 predictive text input mode allows you to enter words easily with a minimum number of key presses. As you press each key, the handset begins to display the characters that it thinks you are typing based on a built-in dictionary. As new letters are added, the word changes to reflect the most likely candidate from the dictionary.

1. When you are in the T9 predictive text input mode, start entering a word by pressing keys  to . Press one key per letter.
 - ▶ The word changes as letters are typed - ignore what's on the screen until the word is typed completely.
 - ▶ If the word is still incorrect after typing completely, press the  key once or more to cycle through the other word options.

Example

Press to type Good.

Press the key to get Home.

- ▶ If the desired word is missing from the word choices list, add it by using the ABC mode.
2. Enter the whole word before editing or deleting any keystrokes.
 3. Complete each word with a space by pressing the key.

To delete letters, press the key.

Press and hold down the key to erase entire words.

Using the ABC Mode

Use the to . keys to enter your text.

1. Press the key labelled with the required letter:
 - ▶ Once for the first letter
 - ▶ Twice for the second letter
 - ▶ And so on
2. To insert a space, press the key once. To delete letters, press the key. Press and hold down the key to clear the display.

Using the 123 (Number) Mode

The 123 Mode enables you to enter numbers in a text message(a telephone number, for example).

Press the keys corresponding to the required digits before manually switching back to the appropriate text entry mode.

Using the Symbol Mode

The symbol mode enables you to enter various symbols or special characters.

To enter a symbol, select [Options] → [Insert] → [Symbol]. Use the navigation and numeric keys to select the desired symbol and press the key.

Key description

Each key can be used for several symbols. There are shown below.

Key	Characters in the order display	
	Lower case	Upper case
1	.,?!1	.,?!1
2	abc2àáâãäåæç	ABC2ÀÁÂÃÄÅÆÇ
3	def3èéêë	DEF3ÈÉÊË
4	ghi4ìíîï	GHI4ÌÍÎÏ
5	jkl5£	JKL5£
6	mno6ñòóôõöøœ	MNO6ÑÒÓÔÕÖØŒ
7	pqr7ß\$	PQR7ß\$
8	tuv8ùúûü	TUV8ÙÚÛÜ
9	wxyz9	WXYZ9
0	Space 0	Space 0

Special Functions

Multi Tasking

Task Manager works when the phone is open, displaying on the main display the list of modules currently running. It uses this list to control switching between modules, present status confirmation and close modules.

Task Manager can be accessed by pressing the Smart key on the side of the phone under the volume keys.

- **Side Smart key (short press, phone open)**

Displays the menu list on the main display. This function ensures that the menu is displayed regardless of which module is running.

Music Player Quick Launcher

Music Launcher works in idle, when the phone is closed. It allows to launch immediately the music player without opening the phone. Music Launcher can be accessed by long-pressing the Smart key on the side of the phone.

- **Side Smart key (long press, phone closed)**

Displays the Music menu on the sub-LCD. Options can be selected with the volume side keys and confirmed with new presses on the Smart key.

You can launch a menu by pressing the OK key in the idle screen. Move to a desired item and press the OK key to go into the sub menu.

From main menu you can also go into a submenu by directly pressing the corresponding numeric key as follows. The main menu consists of the following high-level and sub menus.

1. [SAT services] (with network operator specific service name stored on SIM card) or Profiles (if SAT not supported by SIM)

- General
- Silent
- Outdoor
- Vibrate only
- Headset
- Car
- User defined 1
- User defined 2

2. My Media

- Photos
- Pictures
- Sounds
- Music
- Games & more
- Videos
- Bluetooth data
- External memory

3. Call register

- Missed calls
- Received calls
- Dialled calls
- All calls
- Call durations

4. Messages

- New message
- Inbox
- E-mail inbox
- Drafts
- Outbox
- Sent
- Voice mail
- Templates
- Settings

5. t-zones

- How to access t-zones

6. Contacts

- Add new
- Search
- Speed dials
- Group manager
- Own number
- Settings

7. Organiser

- Alarm clock
- Calendar
- To do
- Memo
- Date counter
- Voice recorder
- Calculator
- Unit converter
- World time
- Stop watch

9. Settings

- Profiles (for SAT SIM)
- Date & Time
- Favourites
- Phone settings
- Call settings
- Connectivity
- Security
- Memory status
- Handset info.
- Internet
- Reset settings

8. Camera

- Take photo
- Take video
- Memory status

Depending on the support or not of SAT (i.e. SIM Application Toolkit) services on the SIM card, the menu 1 may be different.

In case the SIM card supports SAT services, menu 1 will be the operator specific service name stored on the SIM card, for instance “Special”. Please refer in that case to the information provided with your SIM card for further information on how to use the related options.

In case the SIM card does not support SAT services, menu 1 will be “Profiles” and allows you to select or customize some of the alert profiles. The following describes this menu Profiles.

You can select ring tone or vibration for an incoming call and configure the sound and volume of the ring tone, button sound, and sound effect, according to a profile. The profiles provided include [General], [Silent], [Outdoor], [Vibrate only], [Headset], [Car], [User defined 1], and [User defined 2]. Select a profile, and press the OK button to activate the profile. The [Silent], [Vibrate only], [Headset], and [Car] profiles do not have an Option menu. Move the cursor to the corresponding profile. Then menus available are displayed on the softbar below the screen. Select the Edit menu for [General], [Outdoor], [Headset], [Car],

[User defined 1] & [User defined 2] profile to change the configuration.

The different list of options available when each profile has been selected for editing.

1. Alert type
2. Ringtones
3. Effect tones

Alert type

This option determines the incoming call notification mode. You can select from [Ringing], [Vibration], [Light only], [Ring & vibration], [Vibration after ring], [Ring after vibration], [Max. ring & vibration].

Ringtones

- a. Voice call tone:** This option determines the notification (incoming call) from Line1
- b. Video call tone:** This option determines the incoming Video telephony call.
- c. Volume:** This option determines the ring tone volume for incoming call notification.

Effect tones

- a. **Key tone:** Key tone effect This option determines the key tone that is played when a key is pressed.
- b. **Feedback tone:** This option determines the warning tone that is played for: [Feedback popup], [No network], [No battery], [When Delete all execute], [Factory default press], [Memory full], [Warning popup].
- c. **Effect tone volume:** This option determines the volume at which the key tones & Feedback tone need to be played.

To change Effect tones and its volume:

1. Select Effect tones and press Select.
2. Choose from the list of Options Key tone, Feedback tone, Effect tone volume.
3. Change the settings and press Done to save the changes.

2.1 Photos

You can save photos taken using the camera in the Photos folder and create new folders to manage them. You can also save selected files as animated Gifs and send multiple files to other people.

The detailed functions offered in submenu Options are as follows:

1. Create a new folder.
 2. View/Edit/Move/Copy/Delete/Delete all/Rename photo(s).
 3. Mark/Unmark one or all photo(s).
 4. Send a photo via MMS, Email or Bluetooth.
 5. Set photo as wallpaper on main or front display.
 6. Start or set (normal or full screen, at what pace) a slide show.
 7. Create with different photos an animated GIF file (Up to 10 files of 176X220 resolution and the limitation of file size is 2Mbyte for displaying).
 8. Sort by name, date or file extension.
 9. View the photo(s) as simple or detailed list, in a grid.
- *. Memory info (handset or external memory card).
- #. View file information.



2.2 Pictures

The folder Pictures consists of More pictures, an embedded link for downloading pictures from t-zones, and My pictures as default folder for downloaded pictures.

2.2.1 More pictures

You can download contents from T-Mobile wireless portal site.

Please note that additional cost may occur when using online services.

2.2.2 My pictures

You can here manage, send or set as wallpaper downloaded pictures.

The detailed functions are as follow:

1. Create a new folder.
2. View/Edit/Move/Copy/Delete/Delete all/Rename picture(s).
3. Mark/Unmark one or all picture(s).
4. Send a picture via MMS, E-mail or Bluetooth if not protected by Digital Rights Management (DRM).
5. Set a picture as wallpaper for the main or front display.
6. Start or set (normal or full screen, at what pace) a slide show.
7. Create with different pictures an animated GIF file.
8. Sort the files by name, date or file extension.
9. View the picture(s) in a simple or detailed list, or in a grid.
- *. Memory info (handset or external memory card).
- #. View file information.

You can view JPEG, GIF, PNG, BMP and WBMP images with the Image Viewer. The images are displayed in thumbnail images. 9 thumbnail images are displayed on a screen at a time. You can use various functions by using the [Option] key.



When a file selected the following Option keys will be displayed.

- **New Folder:** You can create a new folder within the folder currently selected.
- **Files:** You can view, edit, move, copy, delete, delete all and rename a file.

The detailed functions are as follows:

1. View/Edit/Rename/Move/Copy/Delete/Delete all.
2. Send a file via MMS, E-mail and Bluetooth if not protected by Digital Rights Management(DRM).
3. Full
4. Zoom
5. Set as wallpaper
6. Slide show

7. Go to list

8. file info.

- **Mark/Unmark:** Using the Mark function, you can send, delete, move and copy multiple files.
- **Send via:** You can send a file via E-mail, MMS and Bluetooth.
- **Set as wallpaper:** You can set a selected file as wallpaper, i.e. background image on the main or front display.
- **Slide show:** You can run the slide show.
- **Make animated GIF:** You can create a GIF animation.
- **Sort by(Name, Date, Type):** You can list files by sort.
- **View by(Simple list/Detailed list/Grid):** You can select a view type.
- **Memory info.:** You can view the current phone memory and external memory status.
- **File info.:** You can view the file information.

Press the soft 2 key to execute [Send] function immediately.

Select a thumbnail in the Thumbnail list screen, and select [View] to view the image enlarged.

In the large image screen, you can view in full screen mode by clicking [Full] at the centre, and you can execute the [Send] function using the soft 2 key.

Using the Options menu, you can use the following functions.

Using [Files] menu, you can delete, rename and edit a file and you can view the file information. Using the Edit menu, you can rotate, resize and crop an image and you can insert text or an effect.

Select [Files] and select Edit option to enter the Edit window.

In the Edit window, you can use the following different functions using the Option key.

- **Files:** You can open, move, copy, delete and rename a file. You can also view the file information.
 - Select [**Save**] to save the edited image.
 - Select [**Rotate**] to rotate the image by 90°, 180° or 270°.
 - Select [**Resize**] to resize the image to smaller size.
 - Select [**Insert**] to add Text, Frame, Element.

- Select [**Edit object**] to use the Defect & Clipping functions.
 - Select [**Effect**] to apply the desired effect to the image.
 - Select [**Mirror**] to reverse as a mirror image (right<left).
 - Select [**Undo/Redo**] to undo or redo the last operation on the image.
- **Send via:** You can send a file via E-mail, MMS and Bluetooth.
- **Full:** You can view in full screen mode.
- **Zoom:** You can select zoom level, 2X, 4X, or 8X.
- **Set as wallpaper:** You can set a selected file as as wallpaper, i.e. background image on the main or front display.
- **Slide Show:** You can run the slide show.
- **Go to list.**
- **File info:** You can view the file Information.
- [] Copyright protected media contents. (DRM(Digital Rights Management))
You can't render this picture.

[] Expired copyright protected picture. You render use this picture. You can updates some media contents at **File manager** → **Options** → **2. Files** → **2. Activate**

2.3 Sounds

The folder Sounds consists of t-music, an embedded link for downloading sounds from t-zones, and My sounds as default folder for recorded or downloaded sounds.

2.3.1 t-music

You can download contents from T-Mobile wireless portal site.

Please note that additional cost may occur when using online services.

2.3.2 My sounds

You can here manage, send or set as ringtones downloaded sounds.

The detailed functions are as follow:

1. Play the sound.
2. Create a new folder.

3. Move/Copy/Delete/Delete all/Rename sound(s).
4. Mark/Unmark one or all sound(s).
5. Send a sound via MMS, E-mail or Bluetooth if not protected by Digital Rights Management (DRM).
6. Set a sound as ringtone for voice or video incoming calls.
7. Sort the files by name, date or file extension.
8. View the sound files(s) in a simple or detailed list, or in a grid.
9. Memory info (handset or external memory card).
- #. View file information.

When option 1. Play is selected, the sound will be played with the Media Player. To pause playback, press the OK key during the playback. To resume the paused playback, press the OK key once again.

To set an area to repeat continuously, press Right Soft key (A->B) to mark the point where you want to the area to start and then press Right Soft key (A->B) again to mark the point where you want the area to end. The selected area will then repeat continuously. Press Right Soft key (A->B) once again, while playing the selected area to release Area Repeat mode.

You can enter the Option menu by pressing the left soft key where you use the various utility functions using the up and down keys.

Move to the desired menu using the up and down key and press the OK key.

1. **Background Play:** You can play a file as Background music.
2. **Play/Pause:** You can play, or pause playing a file.
3. **Send Via:** You can send a file via MMS, E-mail and Bluetooth if not protected by Digital Rights Management (DRM).
 - **Multimedia msg:** You can send a file being played via MMS.
 - **E-mail:** You can send a file being played via E-mail.
 - **Bluetooth:** You can send a file being played via Bluetooth.
4. **Ringtone:** A sound can also be set as a ring tone for incoming voice or video calls.
5. **Mute/Unmute:** If the Volume is set at more than 0, the Unmute mode goes active, and if the Volume is at 0, the Mute mode is activated.

- 6. Set repeat:** You can set the Repeat mode.
- **None:** You can release the Repeat mode.
 - **Current file:** You can repeat the current file.
 - **All files:** You can play all files in the current directory.
 - **Shuffle:** You can play a file randomly.
- 7. Area Repeat(A->B):** You can set the Area Repeat mode.
- 8. Player settings:** You can apply Visual effects & Player skins & Equalizer to the player.
- 9. File Info:** You can check Information on a file being played (File name, Size, Date, Type, Protection status).

2.4 Music

2.4.1 Mobile Jukebox

You can easily download music clips from t-zones, the mobile Internet portal by T-Mobile. Selecting Mobile Jukebox guides you directly to a rich variety of music, ranging from current charts to different music categories. Please note that additional cost may occur when using online services.

2.4.2 My music

You can manage downloaded music in this folder. The detailed functions are as follows:

1. Play the music file.
2. Create a new folder.
3. Move/Copy/Delete/Delete all/Rename music file(s).
4. Mark/Unmark one or all music files(s).
5. Send a music file via MMS, E-mail or Bluetooth if not protected by Digital Rights Management (DRM).
6. Set a music file as ringtone for voice or video incoming calls.
7. Sort the files by name, date or file extension.
8. View the music files(s) in a simple or detailed list, or in a grid.
9. Memory info (handset or external memory card).
- #. View file information.

2.4.3 Playlists

You can make a list of downloaded music files and play a selected file in the list.

How to make a list:

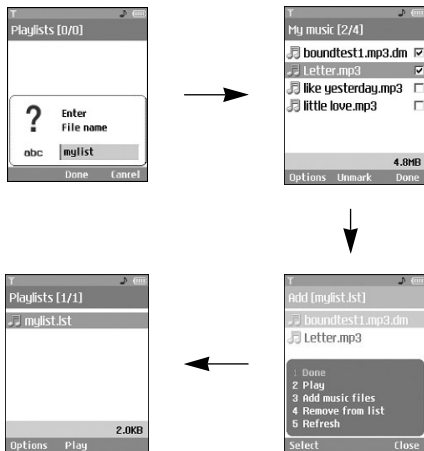

2.5 Games & more

2.5.1 t-games

You can easily download games and other applications by selecting this menu. When you select this menu, the browser application will be launched and you will be directly connected to the games section of t-zones. The downloaded applications will be stored in the 'My games & more' folder by default. Please note that additional cost may occur when using online services.

2.5.2 My games & more

The downloaded games & other applications are stored in this folder. When you select 'My games & more' menu, you can see the list of installed applications. You can open the installed applications for use. When the free space of the file system is less than 64 kilo bytes, Java can not be launched. You will see the error message 'Insufficient space'. After deleting some files from the common memory space, you can launch the Java application without error.

Options

A menu displaying the various option settings is displayed. These options when changed will affect only the selected Java application. Each Java application has different settings. Changes made on one Java application do not reflect on the other Java applications.

1. Open

Opens the selected Java application.

2. Delete

Deletes the selected Java application. You can't delete the preinstalled Java application because this option is not displayed for the pre-installed Java application.

3. File info.

Displays the file information of the selected Java application file. The name(application name), Vendor, Version(application version), Size(application's jar file size), Date(installed date), and Authentication information associated with the file are displayed. The authentication information may be different for a signed Java application.

When the application is signed, the name of the verified certificate is displayed, and 'View Cert.' soft menu is displayed as the left soft key.

But, you can't see this soft menu at first since pre-installed application (ActionInLife) isn't a signed Java application.

If you download and install a signed application, you can see the name and details of certificate in File info.

- View Cert(only in case of certified application)

If the selected Java application is a signed by a trusted party then the detailed certificate information will be displayed.

4. Permission settings

A Java application downloaded from the internet has a set of default permissions that the user can modify. Such modifications performed on one Java Application are not reflected on the other ones. Please note that the availability of these permission settings may depend on the type and authentication of the Java application.

In case of a pre-installed Java application, Permission settings can not be changed, all permissions are granted without any prompt.

In case of signed Java Applications, the permissions settings are pre-defined and can not be changed. For each option below, you can change the Permission settings.

- Net access

This menu is used to select the behaviour of the Java application when it tries to connect to the internet.

! Note

- **Prompt each time**

If this option is selected, the application will prompt the user each time the Java application tries to access the internet.

- **No, don't ask any more**

When the application attempts to make a network access connection, the attempt will not be successful without prompt.

- Application auto invocation

A registered special SMS or Event may try to invoke an already residing Java application in the phone.

The user can define the action to be taken when this type of event occurs.

! Note

- **Prompt each time**

If this option is selected, the application will prompt the user each time some special event tries to invoke a java application.

- **No, don't ask any more**

If some other specially registered event tries to open a Java application, the attempt will not be successful.

- Messaging

This menu is used to select the behaviour of the Java application if it tries send message(SMS). The user can define the settings when this type of action is performed.

! Note

- **Prompt each time**

If this option is selected, the application will prompt the user each time the Java application tries to send the message.

- **No, don't ask any more**

When the application attempts to send a message, the attempt will not be successful.

- Multimedia recording

This menu is used to select the behaviour of the Java application if it tries to capture a still image with a camera.

! Note

- **Prompt each time**

If this option is selected, this application will prompt the user each time it tries to capture a still image with a camera.

- **No, don't ask any more**

When the application attempts to capture a still image with a camera, the attempt will not be successful.

- Read user data access

This menu is used to select the behaviour of the Java application if it tries to read data from Personal Information of the mobile.

! Note

- **Prompt each time**

If this option is selected, the application will prompt the user each time the Java application tries to read from the personal information of the phone.

- **No, don't ask any more**

When the application attempts to read PIM data, the attempt will not be successful.

- Write user data access

This menu is used to select the behaviour of the Java application if it tries to write in the personal Information of the phone.

! Note

- **Prompt each time**

If this option is selected, the application will prompt the user each time the Java application tries to write in the personal information of the phone.

- **No, don't ask any more**

When the application attempts to write PIM data, the attempt will not be successful.

- File connection

This menu is used to select the behaviour of the Java application if it tries to connect to a file. The user can define the settings when this type of action is performed.

! Note

- **Prompt each time**

If this option is selected, the application will prompt the user each time the Java application tries to connect to a file.

- **No, don't ask any more**

When the application attempts to make a file connection, the attempt will not be successful.

- Phone call

This menu is used to select the behaviour of the Java application when it tries to dial a phone number.

! Note

• Prompt each time

If this option is selected, the application will prompt the user each time the Java application tries to dial to a phone number.

• No, don't ask any more

When the application attempts to dial a phone number, the attempt is stopped.

5. Profile settings

When you select this option, you can see the list of the Profile settings. Each profile has detailed setting values, you can see the detailed setting values by selecting 'View' soft menu. One of the profiles has to be selected for each application, and the selected profile will be used when the application tries to connect to the network.

The default selected profile is normally same with the browser's default profile (the only exception is Austria version, in case of Austria version, the default profile is different from the browser's default

profile). If you change browser's default profile, Java applications' default profile will be changed as well (Austria version's default profile of Java applications is not changed at all). The browser's default profile could be changed by the '9.* Internet' menu. For the detailed information, please refer to "How to connect to Internet (Internet settings)" section.

You can also change the profile for each application.

To set a specific profile to each application, the only thing you have to do is select one profile from the profile list. When you select one profile, it is just set to the selected application. This change made on one application never be reflected on others. By using this way, all the applications can have different profiles. From the profile settings fields, ProxyIP address, Proxy port, and Access point fields are used for network access.

To add, delete, and edit the profile lists, please refer to the '9.* Internet' menu of this manual.

6. Memory info.

You can view the memory usage information for the applications. It displays the total memory, used memory & the free space available for the applications.

2.6 Videos

The folder Videos consists of t-movies, an embedded link for downloading videos from t-zones, and My videos as default folder for recorded or downloaded video clips.

2.6.1 t-movies

You can download contents from T-Mobile wireless portal site.
Please note that additional cost may occur when using online services.

2.6.2 My videos

You can here manage or send downloaded or captured videos clips.

The detailed functions are as follow:

1. Play the video clip.
2. Create a new folder.
3. Move/Copy/Delete/Delete all/Rename video clip(s).
4. Mark/Unmark one or all video clip(s).
5. Send a video clip via MMS, E-mail or Bluetooth if not protected by Digital Rights Management (DRM).

6. Sort the files by name, date or file extension.
7. View the video files(s) in a simple or detailed list, or in a grid.
8. Memory info (handset or external memory card).
9. View file information.

You can view a video using the video player. Video files are displayed in the list as thumbnails. You can select a desired video by using the Up, Down, Left, and Right keys. Select a desired video and select Play to view the recorded video.

Select [Send Via] to attach the selected video to an MMS message and an Bluetooth service.

- **New Folder:** You can create a new folder within the folder currently selected.
- **Files:** You can open, move, copy, delete and rename a file. You can also view the file information.
- **Mark/unmark:** Using the Mark function, you can send, delete, move and copy multiple files. You can make a GIF animation if the file is an image file.
- **Send via:** You can send a file via E-mail, MMS and Bluetooth, if file is not protected by Digital Rights Management (DRM).
- **Sort by(Name, Date, Type):** You can list files by sort.

- **View by(Simple list/Detailed list/Grid):** You can select a view type.
- **Memory info.:** You can view the current phone memory and external memory status.
- **File info.:** You can view the file information.

When option 1. Play is selected, the video clip will be played with the Media Player. To pause the playback, press the OK key during the playback. To resume the paused playback, press the OK key once again.

To capture the screen shot, press the right soft key when the playback is paused.

To view the current playback in full screen, press the right soft key during the playback.

To return to the previous screen size, press the right soft key once again in the full screen mode.

1. **Pause/Play:** You can play or pause playing a file for a moment.
2. **Send via:** You can send a file.
 - **Multimedia msg.:** You can send a file being played via MMS.
 - **E-mail:** You can send a file being played via E-mail.

- **Bluetooth:** You can send a file being played via Bluetooth if the file is not protected by Digital Rights Management (DRM).

3. **Full screen:** You can enlarge the video screen being played to full view (activating only in the Play mode).
4. **Capture:** You can save what is on the paused screen in an image file (activating only in the Pause mode).
5. **Mute/Unmute:** If the Volume is set to more than 0, the Mute mode goes active and if the Volume is set to 0, the Unmute mode goes active.
6. **Player settings:** You can apply Visual effects & Player skins & Equalizer to the player.
7. **File info.:** You can check information on files being played (File name, Size, Date, Type, Protection status).
8. **Add bookmark**

2.7 Bluetooth data

The files received using Bluetooth are saved in this folder. You cannot create a sub-folder within the Bluetooth data folder.

Although all types of files can be saved here, you can only copy or move files managed by My Media. To set

a file as your wallpaper or ringtone, you must copy or move the file into the corresponding folder. For example, you can copy *.jpg files to My Pictures folder, *.mp3 files to My Sounds and *.3gp files to My Videos. You cannot copy or move files that are not managed by My Media.

The options displayed depend on the type of file selected. For instance, in case of an image, the following functions are supported.

1. Open/Edit/Move/Copy/Delete/Delete all/Rename file(s).
2. Mark/Unmark one or all file(s).
3. Send a file via MMS, E-mail or Bluetooth if not protected by Digital Rights Management (DRM).
4. If relevant, set an image as wallpaper for the main or front display.
5. If relevant, start or set (normal or full screen, at what pace) a slide show.
6. If relevant, create with different pictures an animated GIF file.
7. Sort the files by name, date or file extension.
8. View the files(s) in a simple or detailed list, or in a grid.

9. Memory info (handset or external memory card).

*. View file information.

2.8 External memory

If you purchase an optional external TransFlash memory card, you can manage more content. Refer to the section “How to use a TransFlash (TFlash) memory card” to learn how to insert and remove the memory card. You can manage content using the following menus as you do on your phone.

1. Photos

Provides the same functions as those in the Photos menu on your phone. If you have external memory installed on your phone, you can save pictures taken by the camera directly to the external memory. Although all the functions are the same as those on your phone, the wallpaper function is not supported. To set a picture as your wallpaper, you must copy or move the picture to the phone.

2. Pictures

Provides the same functions as those in the My Pictures menu on your phone.

3. Sounds

Provides the same functions as those in the My Sounds menu on your phone.

4. Music

Provides the same functions as those in the My Music menu on your phone.

5. Videos

Provides the same functions as those in the My Videos menu on your phone.

3. Call register

You can view missed, received, dialled and entire call records.

Each call record menu provides the following functions.

- You can make a voice or video call to the number in the call record.
- You can save the number in the call record in the Contacts.
- You can send a message to the number in the call record.
- You can view detailed information of the call records such as the date, time and call time.
- You can clear call records.

3.1 Missed calls

Allows you to view missed call records, make a call, send a message, and save the number in the Contacts.

3.2 Received calls

Allows you to view received call records, make a call, send a message, and save the number in the Contacts.

3.3 Dialled calls

Allows you to view dialled call records, make a call, send a message, and save the number in the Contacts.

3.4 All calls

Allows you to view all of the missed, received, and dialled call records. You can make a call, or send a message to the number you have selected from the records. You can also save the number in the Contacts.

3.5 Call durations

You can view call time by types. Press Options key to choose whether partial initialization or entire initialization. Also Press Clear key for initialization of selected duration type. Initialisation will require your Security code.

3.5.1 Last Call

Shows the latest call time in units of hour/minute/second.

3.5.2 Received calls

Shows incoming call time.

3.5.3 Dialed calls

Shows outgoing call time.

3.5.4 All calls

Shows total call time.

4. Messages

4.1 New message

4.1.1 Text Message

1. Press the OK key in idle mode and select Messages. (You can also use the left navigation key from idle to directly access the Messages menu)
2. Select New Message and press the OK key.
3. Select Text Message and press the OK key.
4. Enter a number in the To field directly or search for a number from the Phonebook.
5. Pressing the Down key shows another To field in which you can enter a number. (You can enter up to 10 numbers) (If you press the key without entering a number, the focus is moved to the Message field)
6. If you press the Down key, the focus is moved to the Message field.
7. Enter your message in the Message field.



Option Menus in To Field

1. Press the left soft key. A popup window will appear.
2. Select 1 Search from the popup menu and press OK or the Right key. The second popup window will appear.
 - a. Message log from the second popup menu (Search from the message log).
 - b. Call log from the second popup menu (Search from the Call log).
 - c. Contacts from the second popup menu (Search from the Phonebook).
3. Press popup menu 2 and press the OK key: Send message
4. Press popup menu 3 and press the OK key: Save to draft
5. Press popup menu 4 and press the OK key: Exit
6. Press the right soft key or Back key to the previous screen or the To field.



Option Menus in Message Field

1. Press the left soft key. A popup window will appear.
2. Select 1 Insert from the popup menu and press OK or the Right key. The second popup window will appear.
 - a. Add New Slide from the second popup menu
 - b. Add CC from the second popup menu
 - c. Add Subject Title from the second popup menu
 - d. Enter Symbol from the second popup menu
 - e. Enter Template from the second popup menu
 - f. Contacts from the second popup menu
 - g. Insert Photos from the second popup menu
 - h. Insert Pictures from the second popup menu
 - i. Insert Sounds from the second popup menu
 - j. Insert Videos from the second popup menu
 - k. Insert New photo from the second popup menu
 - l. Insert New sound from the second popup menu
 - m. Insert New Video from the second popup menu (Selecting a menu other than d, e, and f displays Multimedia message screen.) (Input procedures are the same as those for the Multimedia message.)

3. Press the popup menu 2 Dictionary and press the OK key to select a language.
4. Press the popup menu 3 Send Message and press the OK key to send the message.
5. Press the popup menu 4 Save to draft and press the OK key to save the message.
6. Press the popup menu 5 Exit and press the OK key to exit the Message window.

In Text Message,

If you insert an image, a sound, a video clip, CC or subject, the screen is changed to Multimedia Message screen.

4.1.2 Multimedia message

To send a video you have stored on your phone:

1. Press the OK key from idle and select Messages.
2. Select New Message and press the OK key.
3. Select Multimedia Message and press the OK key.



4. Enter phone numbers in the To and CC fields.

Select Options → Search → Contacts or press OK in the TO or CC fields to select a phone number from the Phonebook.

5. Enter the subject of the message in the Subject field.

6. Enter your message in the Message field.

7. Select Options → Insert.

1. Photos Menu

- The photos saved on the phone are displayed.
- Select a photo and select the Select Options menu or press OK.
- The selected photo is inserted into the Message window. (One photo per slide).

2. Pictures Menu

- The pictures saved on the phone are displayed.
- Select a picture and select the Select Options menu or press OK.
- The selected picture is inserted into the Message window. (One picture per slide).

3. Sounds Menu

- The sounds saved on the phone are displayed.
- Select a sound and select the Select Options menu or press OK
- The selected sound is inserted to the Message window (One sound per a slide)

4. Videos Menu

- The video clips saved on the phone are displayed
- Select a video clip and select the Select Options menu or press OK.
- The selected video clip is inserted into the Message window. (One video clip per slide)

5. New photo

- Camera
- Take a picture
- Select Image to be taken immediately and to be inserted to the message → It is inserted to the Message window (One photo clip per slide).

Select 6. New sound

- Voice Recorder
- Recording

- Select sound to be taken immediately and to be inserted to the message → It is inserted to the Message window (One sound clip per slide)

Select 7. New video

- Camcorder
- Recording
- Select video to be taken immediately and to be inserted to the message → It is inserted to the Message window (One video clip per slide)

8. Select Send Message from the Options Menu or press the Right key → The message is transmitted.

< Option Menus >

1.1 Search

1.1.1 Message Log

- : Select and enter a phone number from the list of phone numbers to which you have recently sent a message.

1.1.2 Call Log

- : Select and enter a phone number from the list of phone numbers to which you have recently made a call.

1.1.3 Contacts

- : Phonebook screen appears → You can select and enter a phone number.

1.2 Send Message

- : Select this menu to send the created message.

1.3 Save to draft

- : Select this menu to save a draft of the message.

1.4 Save to multimedia template

- : Select this menu to save the created message as a template.

1.5 Preview

- : Select this menu to preview the created message before transmission.

1.6 View Objects

- : Select this menu to view all the files attached to all slides of the current message.

1.7 Set Slide

- : Select this menu to configure the play time and the background colour of each of the slides.

1.8 Remove

: Select this menu to remove the current slide or an object included in the current slide (represented by Image/Video/Sound).

1.9 Move

: Select this menu to move to the previous or the next slide.

1.* Exit

: Select this menu to stop creating the current message and return to the previous screen.

Send a multimedia message straight from your camera, camcorder or sound recorder.

1. After taking a picture with the camera, recording a video with the camcorder or recording sound with the Sound Recorder.
2. Select Send.
3. Select Via Multimedia msg.
4. The selected image, video, or sound is inserted into the Multimedia msg.
5. Select Send Message from the Options Menu or press the right soft key → The message is transmitted.

4.1.2.1 Viewing MMS messages

To preview MMS message

1. Select Preview from the Options Menu to preview a created MMS.
2. If the message is too long to be displayed on screen, the contents of the message are automatically scrolled.
3. Press the Pause key to pause playback of the message, and press the Play key to resume playing the message.

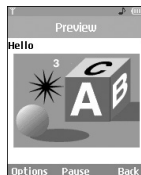

- Press the Play key to play the message.

When the message has finished playing, the detailed view screen appears. If you want to play the message again, click Play soft key.

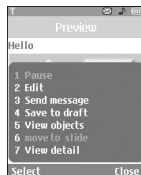

- You can use the following functions using the Options key from the Play screen.

- **Play/Pause:** Plays the message or pauses message playback.



- **Edit:** Displays the Message edit screen.
- **Send message:** Sends the message.
- **Save to draft:** Saves the message in the Outbox.
- **View objects:** Displays the screen (Object View Screen) in which you can view the audio, image, and video files included in the message. You can also save those files in different names to the specified location.
- **Mute(or Unmute):** This menu allows you to determine whether to mute the sound when there is an audio or a video file included in the message.
- **Move to slide:** Move to the selected Slide.
- **View detail:** Displays the Detailed View screen. It shows you detailed information of messages.

-You can use the following functions using the Options key from the detailed view screen

- **Play:** Plays the message.
- **Edit:** Displays the Message edit screen.
- **Send message:** Sends the message.
- **Save to draft:** Saves the message in the Outbox.
- **View objects:** Displays the screen (Object View Screen) in which you can view the audio, image, and video files included in the message.
- **Mute(or Unmute):** This menu allows you to determine whether to mute the sound when there is an audio or a video file included in the message.

Viewing MMS messages in the Inbox, Outbox and Sentbox

1. Select an MMS message to view its contents.
2. If the message is too long to be displayed on a screen, the contents of the message are automatically scrolled.
3. Press the Pause key to pause playback of the message, and press the Play key to resume playing the message.

4. Move to a desired message by using the left and right direction keys.

If you play a MMS message, detailed view screen appears after message playing.

- Press the Play key to play the message.
- Press the Reply key to reply the message. (Inbox)
- Press the Edit key to move to the message edit screen. (Outbox/Sent)
- You can use the following functions using the Options key.

[Inbox / Detailed View Screen Menus]

- **Play/Pause:** Plays the message or pauses message playback.
- **Reply:** Creates a reply to the selected message.
- **Reply all:** Creates a reply to all recipients (copy of originator and CC addresses) of the selected message.
- **Forward:** Forwards the selected message.
- **Call:** Call back to the originator.
- **Add to Contacts:** Saves the sender's number to the phonebook.

- **Create message:** Displays the Edit screen where you can create a new message.

- **Get:** Displays a screen (Get number/e-mail address/web address screen) that shows the number/e-mail address/web address included in the message.

- **View object:** Displays the screen (Object View Screen) in which you can view the audio, image, and video files included in the message.

- **Mute/Unmute:** This menu allows you to determine whether to mute the sound when there is an audio or a video file included in the message.

- **Delete:** Deletes the selected message.

[Inbox / Play Screen Menus]

- **Play/Pause:** Plays the message or pauses message playback.
- **Reply:** Creates reply to the selected message.
- **Reply to all:** Creates reply to all recipients (copy of originator and CC addresses) of the selected message.
- **Forward:** Forwards the selected message.
- **Call:** Call back to the originator.

- **Add to Contacts:** Saves the sender's number to the phonebook.
- **New message:** Displays the Edit screen in which you can create a new message.
- **Get:** Displays a screen (Get number/e-mail address/web address screen) that shows the number/e-mail address/web address included in the message.
- **View object:** Displays the screen (Object View Screen) in which you can view the audio, image, and video files included in the message. You can also save those files in different names to the specified location.
- **Mute/Unmute:** This menu allows you to determine whether to mute the sound when there is an audio or a video file included in the message.
- **Delete:** Deletes the selected message.
- **Move to slide:** Move to the selected Slide.
- **View detail:** Displays the Detailed View screen. It shows you detailed information of messages.

[Outbox / Detailed View Screen Menus]

- **Resend:** Resends the message.
- **Edit:** Edits the selected message.
- **Play/Pause:** Plays the message or pauses message playback.
- **Forward:** Forwards the selected message.
- **Add to Contacts:** Saves the recipient's number to the phonebook.
- **Create message:** Displays the Edit screen in which you can create a new message.
- **Get:** Displays a screen (Get number/e-mail address/web address screen) that shows the number/e-mail address/web address included in the message.
- **View object:** Displays the screen (Object View Screen) in which you can view the audio, image, and video files included in the message.
- **Mute/Unmute:** This menu allows you to determine whether to mute the sound when there is an audio or a video file included in the message.
- **Delete:** Deletes the selected message.

[Outbox / Play Screen Menus]

- **Resend:** Resends the message.
- **Edit:** Edits the selected message.
- **Play/Pause:** Plays the message or pauses message playback.
- **Forward:** Forwards the selected message.
- **Add to Contacts:** Saves the recipient's number to the phonebook.
- **New message:** Displays the Edit screen in which you can create a new message.
- **Get:** Displays a screen (Get number/e-mail address/web address screen) that shows the number/e-mail address/web address included in the message.
- **View object:** Displays the screen (Object View Screen) in which you can view the audio, image, and video files included in the message. You can also save those files in different names to the specified location.
- **Mute/Unmute:** This menu allows you to determine whether to mute the sound when there is an audio or a video file included in the message.

- **Delete:** Deletes the selected message.
- **Move to slide:** Move to the selected Slide.
- **View detail:** Displays the Detailed View screen. It shows you detailed information of messages.

[Sent / Detailed View Screen Menus]

- **Edit:** Edits the selected message.
- **Play/Pause:** Plays the message or pauses message playback.
- **Forward:** Forwards the selected message.
- **Add to Contacts:** Saves the recipient's number to the phonebook.
- **Create message:** Displays the Edit screen in which you can create a new message.
- **Get:** Displays a screen (Get number/e-mail address/web address screen) that shows the number/e-mail address/web address included in the message.
- **View object:** Displays the screen (Object View Screen) in which you can view the audio, image, and video files included in the message.

- **Mute/Unmute:** This menu allows you to determine whether to mute the sound when there is an audio or a video file included in the message.
- **Delete:** Deletes the selected message.

[Sent / play screen menus]

- **Edit:** Edits the selected message.
- **Play/Pause:** Plays the message or pauses message playback.
- **Forward:** Forwards the selected message.
- **Add to Contacts:** Saves the recipient's number to the phonebook.
- **New message:** Displays the Edit screen where you can create a new message.
- **Get:** Displays a screen (Get number/e-mail address/web address screen) that shows the number/e-mail address/web address included in the message.
- **View object:** Displays the screen (Object View Screen) in which you can view the audio, image, and video files included in the message. You can also save those files in different names to the specified location.

- **Mute/Unmute:** This menu allows you to determine whether to mute the sound when there is an audio or a video file included in the message.
- **Delete:** Deletes the selected message.
- **Move to slide:** Move to the selected Slide.
- **View detail:** Displays the Detailed View screen. It shows you detailed information of messages.

4.1.3 E-mail

Create e-mail

1. You can create a new e-mail (Electronic mail).
2. Select E-mail from New message, and press the Select key.
3. You can edit the items necessary to create an e-mail message by using the cursor.
4. Move the cursor to To field, and enter the e-mail address of the recipient of the e-mail.
5. Move the cursor to CC (Carbon Copy) field, and enter the reference e-mail address to forward the e-mail.
6. Move the cursor to BCC (Blind Carbon Copy), and enter a hidden reference e-mail address to forward the e-mail without forwarding information.

7. For the recipient (To), reference address (CC) and hidden reference address (BCC) fields only valid e-mail addresses are allowed. When an e-mail address has been specified, another field where you can specify another address appears. You can specify up to 20 recipients for To and CC address fields and 10 recipients for BCC address field.
8. To enter data in the recipient (To), reference address (CC) and hidden reference address (BCC) fields, you can search the Contacts by using the Search key and use the following functions by using the [Option] key.
 - **Search:** Select this menu to insert the address in recent message log or a name saved in Contacts.
 - **Send message:** Send the created e-mail.
 - **Save to drafts:** Select this menu to save the message in Drafts.
 - **View object:** Show the attached file.
 - **Remove:** Remove the attached file.
 - **Exit:** exit this popup menu.
9. Move the cursor to the Subject field and create the subject. You can search Contacts by using the Search key while entering the Subject field, and use the following functions by using the [Option] key.
 - **Insert:** Select this menu to insert the Symbol, templates, and contacts.
 - **Dictionary:** Select this menu to use dictionary.
 - **Send message:** Send the created e-mail.
 - **Save to drafts:** Select this menu to save the message in the draftbox.
 - **View object:** Show the attached file.
 - **Remove:** Remove the attached file.
 - **Exit:** exit this popup menu.
10. You can enter the message contents by moving the cursor to the Message field. Use the following functions by using the [Option] key.
 - **Insert:** Select this menu to insert special characters, templates, and contacts. It's also possible to attach a multimedia file.
 - **Preview:** You can preview the created e-mail before sending it.

- **Dictionary:** Select this menu to use dictionary.
 - **Send message:** Send the created e-mail.
 - **Send settings:** Select this menu to configure the settings of the e-mail that you wish to send.
 - **Save to drafts:** Select this menu to save the message in Drafts.
 - **View object:** Show the attached file.
 - **Remove:** Remove the attached file.
 - **Exit:** Exit this popup menu.
11. You can attach a file by using the [Insert] key in the message field. In the Attach menu, move the cursor to the Video, Audio or Image item, and press the Select key to attach a file. You can attach up to 4 files, and the size of total attached files should be 300K or less. You can change the attached file for another by selecting the attached file name. You can cancel the attached file by using the [Option] key.
 12. When you have finished writing an e-mail, press the Send key to send or save the e-mail.

Send settings

1. Priority

You can configure the priority of the e-mail you wish to send.

You can select either Low, Normal or High.

2. Read reply

You can set whether you want to request a read receipt for a sent e-mail.

4.2 Inbox

1. You can view saved messages. Select a message and then press the Select key to view the message.
2. You can view the previous or next message by using the left and right keys.
3. To view an MMS(Notification) message, select Retrieve in the message view screen. Then the file is transmitted, and you can view the file when the transmission is complete.
4. You can use the following functions by using [Options] key.
 - **Reply:** You can create a reply to the selected message.

- **Forward:** Forwards the selected message. (Not supported for MMS(Notification) and WAP push messages.)
- **Call:** You can call back to the sender.
- **Open:** You can view current message.
- **New message:** You can write a new message.
- **Mark/Unmark:** You can select one or more messages for multiple deletion.
- **Filter:** Displays messages by desired message types.
- **Delete:** Deletes the current message.

4.3 E-mail inbox

Viewing e-mail Message List

1. Select an e-mail account and then press the OK key to view the received e-mail list.
2. Using the Retrieve key, you can retrieve a new e-mail list from the e-mail server of the selected account.
3. In e-mail list, you can use the following functions by using the [Option] key.

- **Reply:** Creates a reply to the selected e-mail. You can write a reply using SMS, MMS or E-mail.
- **Reply all:** Creates a reply to all the recipients.
- **Forward:** Forwards the selected e-mail message to another e-mail address.
- **Open:** Opens selected e-mail.
- **Retrieve:** Retrieves new e-mail messages.
- **New message:** Creates new message.
- **Mark/Unmark:** uses mark/unmark option.
- **Delete:** Deletes an e-mail. Deleted e-mails are temporarily saved in Trash. The following Delete options are provided.

Viewing an e-mail message

1. Select one of the received e-mails and press the OK key to receive the contents of the e-mail.
2. The contents of the received e-mail are automatically displayed in the View screen.
3. You can view the contents of the previous or next e-mail by using the Up/Down key.
4. In the e-mail View screen, you can select the following functions by using the [Option] key.

- **Reply:** Creates a reply to the selected e-mail message.
- **Reply all:** Creates a reply to all the recipients.
- **Forward:** Forwards the selected e-mail message to another e-mail address.
- **Add to Contacts:** Save or update the address of sender.
- **New message:** Write a new SMS, MMS or e-mail.
- **Get:** Extract the number, email address or URL from e-mail message.
- **View objects:** Show the attached file.
- **Delete:** Deletes the selected e-mail message.

Trash

1. You can restore or permanently delete deleted e-mails in Trash.
2. Select Trash in the mailbox and press the OK key to view the deleted e-mail list.
3. Press the Delete key to delete a deleted e-mail permanently.
4. Press the Restore key to restore a deleted e-mail.

5. Using the Option key, you can select the following functions.

- **Restore:** Restores a deleted e-mail.
 - **One:** Restores a selected e-mail.
 - **All:** Restores all the e-mails in Trash.
- **Delete:** Deletes an e-mail permanently.
 - **One:** Deletes the selected e-mail permanently.
 - **All:** Deletes all the e-mails in Trash permanently.
- **Mark/Unmark:** uses mark/unmark option.
- **Exit:** Exit this popup menu.

Note

The e-mails in Trash will not be received again.

4.4 Drafts

1. You can view saved messages. Select a message and then press the OK key to view the message.
2. You can view the previous or next message by using up and down keys.
3. You can use the following functions by using the [Options] key.
 - **Edit:** You can edit messages.

Messages

- **New message:** You can write a new message.
- **Mark/Unmark:** You can select one or more messages for multiple deletion.
- **Filter:** Displays messages by desired message types.
- **Delete:** Deletes the current message.

4.5 Outbox

1. You can view saved messages. Select a message and then press the OK key to view the message.
2. You can view the previous or next message by using the up and down keys.
3. You can use the following functions by using [Options] key.

[For Sending / Waiting Message]

- **New message:** You can write a new message.
- **Cancel:** You can stop sending/waiting status.

[For sending a failed message]

- **Resend:** Resends the selected message.
- **Forward:** Forwards the selected message.
- **Edit:** You can edit messages.

- **New message:** You can write a new message.
- **View error status:** Shows the reason for transmission failure.
- **Mark/Unmark:** You can select one or more messages for multiple deletion.
- **Filter:** Displays messages by desired message types.
- **Delete:** Deletes the current message.

4.6 Sent

Show the messages you sent (Text message / Multimedia message / E-mail).

[Options]

- **Forward:** Forwards the selected message.
- **Open:** Open the selected message.
- **Edit:** You can edit messages.
- **New message:** You can write a new message.
- **Mark / Unmark:** You can select one or more messages for multiple deletion.
- **Filter:** Displays messages by desired message types.

- **Delete:** Deletes the current message.

4.7 Voice mail

You can connect to the voice mail centre.

If there is no selected voice mail centre address, you can insert a new voice mail centre.

4.8 Templates

4.8.1 Text templates

You can add, edit, and delete frequently-used useful phrases.

You can save frequently-used phrases in the input window in advance. You can save these useful phrases using the Options menu.

- Depending on your service provider, the useful phrases such as the following examples are saved as a default.

- I'm at home. Please call
- I'm at work. Please call
- I'm in a meeting, please call me later.
- I'm in a meeting, I'll call you later.

- I'm running late. I'll be there at
- I love you.
- Hi. How are you?
- Sorry, I can't help you on this.
- Good to see you. My phone number is
- Please call me. I'm free now.

4.8.2 Multimedia templates

You can create, edit and view available templates when creating multimedia messages.

Five types of template are saved by default.

Add new

Creates a new template.

Write multimedia message

Creates a multimedia message with the selected template.

View

Displays templates created.

Edit

Edits selected templates.



4.9 Settings

4.9.1 General

4.9.1.1 Message display

- Display after confirm / Only notification

4.9.1.2 Message alert

- None / Once / Every 1 min. / Every 2 mins. / Every 5 mins. / Every 10 mins.

4.9.1.3 Message tone

- You can chose one alert melody among 10 default melodies.

4.9.1.4 Save sent messages

- Yes / No

4.9.2 Text message

4.9.2.1 Message centre

- Input the address of SMSC.

4.9.2.2 Delivery report

- Yes / No

4.9.2.3 Validity period

- 1 hour / 6 hours / 12 hours / 1 day / 2 days / 1 week / Maximum

4.9.2.4 Message types

- Text / Voice / Fax / X.400 / E-mail

4.9.2.5 Character encoding

- Auto / Default alphabet / Unicode

4.9.3 Multimedia message

Select (4). Messages from the top menu. Select Settings from the menu to configure multimedia message related options. Multimedia message setting Menu.

4.9.3.1 Sending options

- 1. Validity period:** Allows you to configure the term of validity for a message when transmitting an multimedia message. The message would be saved in the MMS server only for the configured term.
- 2. Delivery time:** Configures the delivery time of message to the recipient. MMS centre will deliver the message after delivery time.

- 3. Priority:** Configures the priority of a message for multimedia message transmission.
- 4. Message size:** Configures the size of a message for multimedia message transmission. You can make a message up to message size.
- 5. Delivery report:** Determines whether to request a delivery confirmation mail for an multimedia message.
- 6. Read report:** Determines whether to request a read confirmation mail for an multimedia message.

4.9.3.2 Receiving options

- 1. Retrieval mode:** Allows you to determine whether to automatically download an multimedia message when an MMS notification message arrives.
- 2. Delivery report:** Determines whether to allow sending a delivery confirmation mail for a delivery confirmation mail request.
- 3. Read report:** Determines whether to allow sending a read confirmation mail for a read confirmation mail request.

4.9.3.3 MMS centres

This menu allows you to configure network information such as MMSC, and WAP gateway, to send an MMS message.

In the Option menu, you can add or delete a profile by using the left soft key. You can finish the configuration by pressing “Done” key.

A profile name selected by a checkmark is the current configured value. You can view and edit the contents of the profile in the edit mode by pressing the Edit key. The edit screen also appears when creating a new profile under Options. The meanings of the items are given below.

- **Title:** Profile name.
- **MMSC URL:** Enter the MMS centre URL.
- **IP address:** Enter the WAP gateway IP address.
- **Port number:** Enter the WAP gateway port number.
- **Connection mode:** Specify the UDP(CO/CL), the TCP with proxy, the TCP without proxy.
- **Access point:** Specify the access point name (see WAP connection settings.)

Press the Done key(Options) to save the changes and complete MMS setting.

If you have made changes, press the Done key to save the changes and exit.

4.9.4 E-mail

4.9.4.1 Read reply

You can configure settings for receiving and transmitting e-mails such as Read reply, Signature text, Auto retrieve, and E-mail account.

4.9.4.2 Text signature

You can configure a text signature to be attached to the end of an e-mail. The configured signature text is automatically attached to the end the e-mail when it is sent.

4.9.4.3 Auto retrieve

You can configure Auto retrieve to retrieve e-mails automatically from the incoming mail server. When a new mail arrives, an icon appears at the top of the idle screen. You can select that auto receiving time slot have Off, 1, 3, 6 and 12 hours. Please note that additional charges may occur using [Auto retrieve] feature.

4.9.4.4 E-mail account

1. You can create or configure an e-mail account including the e-mail server and user ID.
2. You can edit a selected e-mail account by pressing the Set key.
3. You can select an e-mail account to be used to send an e-mail using the Set key.
4. You can select the following functions using the Option key.
 - **Add new:** Create a new e-mail account.
 - **Delete:** Deletes a selected e-mail account.

Creating a new e-mail account

1. Select Add new from the E-mail account menu options.
2. By moving the cursor to a desired item, you can edit the item to create an e-mail account.
3. Move the cursor to the Title field and enter a title.
4. Move the cursor to the User name field and enter the user name of the e-mail account.
5. Move the cursor to the Password field and configure e-mail account password.

6. Move the cursor to the E-mail address field and configure the e-mail address for outgoing mail.
7. Move the cursor to the Reply e-mail address field and configure the e-mail address to reply to your e-mail.
8. Move the cursor to Maximum receive size and configure the maximum e-mail size. The permissible maximum receive size is no more than 300KB.
9. Move the cursor to Save to server and determine whether to leave a copy of messages on the incoming server or not. You can select On or Off using the List key.
10. Move the cursor to the Outgoing mail server field and configure the outgoing e-mail server.
11. Move the cursor to the Outgoing server port field and configure the mail server port number. In general, the outgoing mail server port number (SMTP) is 25.
12. Move the cursor to the Incoming mail server field and configure the incoming e-mail server.
13. Move the cursor to the Incoming server port field and configure the mail server port number. In general, the incoming mail server port number (POP3) is 110.
14. Move the cursor the Email inbox type and select the email inbox type. You can select one between POP3 and IMAP4.
15. Move the cursor to the Access point field to select an access point to connect to the Internet. You can select a configured access point using the List key.
16. Move the cursor to the auto retrieve item and decide a auto receiving E-mail message as a fixed time slot, You can select on/off using the List key. If you want to utilize this function, there is selected auto retrieve in E-mail setting. But auto retrieve is not selected, you can select auto retrieve in Option.
17. Move the cursor to the SMTP authentication field and decide whether the outgoing mail server requires authentication. You can select On or Off using the List key.
18. Press the Option key and select [Advanced setting]. You can change DNS Server or APOP setting.

Editing an e-mail account

1. Select a desired e-mail account from the e-mail account list and press the Edit key.
2. You can edit desired fields by moving the cursor up and down.

3. When configuration is complete, press the Done key to complete the e-mail account configuration.

4.9.5 Voice mail

You can insert or modify voice mail centre.



4.9.6 Push message

You can configure method for download that push message.

- To receive push message, you can select one of "On", "Off".
- To use or not use auto download option, you can select one of "On", "Off".
- To add allowed list and set as default centre, you can set the allowed list and add allowed list number.

1. Receive	
1. On	Receive all push messages.
2. Off	Does not receive all push messages.
2. Auto download	
1.On	The push message is downloaded automatically
2 Off	To download the push message, use user interaction.

4.9.7 Cell broadcast

In this setting, you can insert or modify your channel ID.

Also, you can change the reception status.

How to access t-zones

You can use your phone for so much more than just texting and talking. t-zones provides information such as news, weather forecast, information on sports or traffic whenever you need it.

In addition, t-zones provides superior multimedia services such as the latest music or ring tones, wallpapers or games for your entertainment and device personalisation.

Press OK key from idle mode and select t-zones using navigation keys. You can also access t-zones by pressing the right soft key in idle mode.

Note

Additional cost may occur when using online services.

6. Contacts

This is an address book function to record and manage contact addresses. Using the Contacts management menu, you can register new contact addresses, or can search for desired addresses by name, phone number, or groups.

6.1 Add new

You can register a new contact address. You can input the name, phone numbers, e-mail addresses, assign it to groups, include memo, company / party, position / occupation, home address, office address, home page URL, ring tone, and avatar or image (photograph) in the contact address information. You can input and manage contact addresses depending on the memory usage.

6.2 Search

Performs the contact address search function. The search operation is performed based on a name as a default. The current search method and results found are displayed in the Search window. On the right side of the screen, an image or avatar registered to the selected contact address appears. You can make a phone call or send a message to the selected phone

number. A Contacts search can be performed based on the phone number, the e-mail address, or group information.

6.3 Speed dials

Using this menu you can manage speed dials. Speed dials are configured between 2-9. You can register speed dials for any number of 5 numbers for a specific contact address, and a contact address may have multiple speed dials.

6.4 Group manager

Using this menu you can manage group information. There are 4 default groups: Friend, Family, Company and School.

You can add, edit and delete groups.

When a bell for a number is not specified, a call from the number sounds the group ring tone assigned to the number for the group.

6.5 Own number

You can save up to own numbers being used in the SIM card.

6.6 Settings

6.6.1 Display data

Determines where phone book data is stored. You can select mobile phone memory, SIM card, or both of them. "Handset & SIM" is the default setting. You can change the setting by using the up and down keys.

6.6.2 Copy all

You can copy contact address information from the phone memory to the SIM or from SIM to the phone memory. You can copy just selected items or all of them.

6.6.3 Move all

You can move contact address information from the phone memory to the SIM or from the SIM to the phone memory. You can move just selected items or all of them.

6.6.4 Delete all

Clears all contact address information. You can delete all contact addresses saved in the mobile phone memory as well as in the SIM card.

7. Organiser

7.1 Alarm clock

If you set the alarm, [Alarm icon] appears on the Indicator bar. The specified alarm sounds at the scheduled time. Press the [OK] key to stop the alarm, and the alarm is released. Press the [Right key] or [Snooze], choose the snooze interval, the alarm sound is stopped and resumed after selected Snooze duration. You can configure up to 5 alarms.

1. **Select your desired alarm to configure in the alarm list.** If there is no alarm, press the right soft key [Add] to add a new alarm.
2. **Set/Cancel alarm:** Set or cancel the alarm using the options for specifying the alarm off or by choosing the alarm time.
3. **Input alarm time:** Input your desired alarm time by specifying Hour and Minute. Choose either 'AM' or 'PM' visible if 12 hour format is specified for the phone.
4. **Select repeat mode:** Select desired repeat mode using the left and right direction keys or from the list pressing the centre key.

5. Select bell: Select the bell to ring at the alarm time, using the left add right direction keys or from the pressing the centre key.

6. Input memo: Input alarm name.

Add here - Select the Snooze - Select the Snooze on/Snooze off option to enable or disable snooze operation when alarm rings.

There is NO Power-off Alarm in TMO.

When you have completed configuration, To save the configuration in Alarm clock, we need to select either "Done" (RSK), or Press LSK ("options") and then select "Done" [Save] to save the changed alarm configuration.

7.2 Calendar

Schedule Inquiry and Search

1. Reference by Months

You can refer to your schedule by months. The cursor is on the current date, and the registered date is underlined.

The schedule saved for the date where the cursor is located is represented by an icon. Pressing the shortcut key 1 moves to the previous year and

pressing key 3 move the and pressing key 5 moves to today. Pressing key 7 moves to the previous month, and key 9 moves to the next month. You can move the date using the up, down, left, and right direction keys.

2. Reference by Days



Pressing the 'View' key in the reference by month moves to reference by day where you can refer to your schedule by days. You can refer to the moving date tab using the left and right key. As a search result, brief schedule contents, repetition set up configuration, and alarm set up configuration are displayed. You can send the schedule to another phone or an Internet site through SMS(Text message) or MMS(Picture message) or E-mail or Bluetooth.

3. Detailed Reference

You can refer to a detailed schedule, that is the whole contents of the schedule configured by user. You can send the schedule to another phone or an Internet site through SMS(Text message) or MMS(Picture message) or E-mail or Bluetooth.

Search Schedule

You can add a schedule. You can configure the date, start time, end time, contents, type of schedule, repetition, alarm of the schedule.

Schedule types	
Appointment	
Anniversary	
Birthday	

Configurable repetition options	
Once	Icon does not exist.
Daily	
Mon ~ Fri	
Sat ~ Sun	
Weekly	
Monthly	
Annually	

Configurable alarm options	
No alarm	Icon does not exist.
On time	
15 mins before	
30 mins before	
1 hour before	
1 day before	
3 days before	
1 week before	

Delete Schedule

1. Delete elapsed schedules

You can delete all elapsed schedules using this function.

2. Delete all

You can delete all saved schedule contents using this function.

Set Up and Release Holiday

You can set up or release user holidays using this function.

Configurable holiday options	
On the day	When a date is configured as an holiday, the date is displayed in red. User configuration is used to configure and cancel holidays of 2 to 10 days.
Weekly	
Monthly	
Yearly	
Multiple setting	

Schedule Notification

If the user has configured the alarm setting, the specified alarm sound will ring. If the notification time is before the schedule start time, you can set up the alarm again.

7.3 To do

You can view, edit and add jobs to do. Jobs to do are displayed in time order. The jobs already finished and unfinished are displayed in different ways.

Add

To add a job, press the 'Add' key in the To do list management screen. Then input date, description and priority for the job.

When input has been completed, press the 'Done' key to save the new job.

Detailed View and Edit

To view detailed job contents, locate the cursor on the desired item in the To do list, and then press the 'OK' key. You can edit and delete a job using 'Menu'. You can also delete multiple or all jobs at a time using the Mark/Unmark key in the menu.

Set Job Status

The jobs set as finished are displayed as cross-out below the unfinished jobs in the To do list. You can set Finished jobs to Not finished by selecting 'Option'.

Select 'Send via' from the 'Option' to send the selected jobs through Text message, Multimedia message, E-mail or Bluetooth.

7.4 Memo

Using the memo management function, you can view and manage saved memo contents, and add new memo.

Add Memo

To add a new memo, press the 'Add'. You can select, number, lower case English, or upper case English using the . You can input useful phrases or symbols. You can save and add the contents of the current memo to the list by pressing the 'Done' key.

Send memo

Select 'Send via' from the 'Option' to send the memo through Text message, Multimedia message, E-mail.

Edit and delete Memo

Locate the cursor on your desired memo, and press the key to view all the contents of the memo. This function shows all the memo contents. You can edit or

delete the contents of a memo using the 'Option' key. You can return to the memo management screen by pressing the 'Back' key. You can select Multiple or All memos using Mark/Unmark option and then delete a memo by pressing the 'Delete' key.

7.5 Date counter

1. Select Date counter menu.
2. Press [Add] and input text in [Title] field.
3. Input desired date in the date field and press [Done].
4. To view detailed job contents, locate the cursor on the desired item in the Date counter List and press [OK]. Details of the selected item With day on which the event occurs is displayed in View detail page.
5. Details of the selected item on which the event occurs is displayed in View detail.
6. You can edit and delete a Date counter item using Options.
7. You can also delete multiple Date counter item Marking multiple items and Delete.

7.6 Voice recorder

Press the left soft key to display the option pop up menu before recording.

Move to the desired menu item using the up and down key and press the OK key.

1. **Quality:** You can select a recording quality from Super Fine, Fine and Normal.
2. **Duration:** You can set the recording duration to Multimedia size, 30 secs, or 1 min.
3. **New Recording:** Select this menu to start recording to a new file.
4. Press the right soft key to close the sub-menu popup window.

Pressing the OK key starts recording. When a recording is started, the recording time and the current recording file name appear on the LCD. To cancel the recording, press the right soft key.

Pressing the left soft key during recording allows you to select either Stop Recording or Cancel Recording.

Select the desired function by using the up and down key and press the OK key.

When you finish the recording, press the OK key to exit. The recorded file is automatically saved in Sounds → My sounds folder(My Media-Sounds-My sounds)

When no recording is in progress, pressing the OK key starts recording on a new file.

When no recording is in progress, press the right soft key to send a recorded file.

Select one from Via Multimedia Msg, Via E-mail, and Via Bluetooth using the up and down keys and press the OK key.

Press the left soft key to select various options after the voice recording.

Select the desired menu using the up and down key and press the OK key.

1. Record New: Select this menu to start a new voice recording.

2. Send via:Select this menu to send therecorded file. Select one from Via Multimedia Msg, Via E-mail, and Via Bluetooth using the up and down keys and press the OK key.

3. Ring tone: You can select a ring tone for a voice and for a video call using the up and down keys.

4. Delete: Select this menu to delete a recorded file.

5. Press the right soft key to close the sub-menu popup window.

7.7 Calculator

You have a calculator that provides 4 calculations of addition, subtraction, multiplication and division as well as scientific functions.

1. Press [Func].

2. Select appropriate function.

3. Select Calculator.

You can input numbers using the number keys, and operators using the up, down, left, and right direction key. You can input a decimal point by pressing the # key. Whenever you press the Clear key, characters are sequentially deleted in reverse direction. Whenever you long press the clear key, all the characters are deleted in reverse in one shot.

When calculation is completed and the result is displayed on the screen, pressing a number clears the previous result and the calculator waits for new input,

even if you did not press AC key. When calculation is completed and the result is displayed on the screen, pressing a symbol saves the result into the symbol, and continues calculation.

7.8 Unit converter

Using this menu, users can convert currency, Surface, Length, Weight, Temperature, Volume & Velocity.

1. Press [Menu].
2. Select appropriate function.
3. Select Unit converter.

7.8.1 Currency

1. Select the Currency menu.
2. Users can set a currency exchange rate using [Rate].
3. Input currency rates for up to 5 currencies equivalent to GBP and then press [Save]. Then you can convert to one currency to another.
4. You can view the value of between 5 currency units.
5. Press [Reset] to clear the current input Field.

6. To exit currency conversion function, press the [Back] key.

7.8.2 Surface

1. Select Surface menu.
2. Select desired unit to convert using [Unit].
3. Input standard unit and view converted value.
4. Press [Reset] to clear the current input Field, and locate the cursor in the input field.
5. To exit Surface conversion function, press [Back] key.

7.8.3 Length

1. Select length menu.
2. Select the desired unit to convert using [Unit].
3. Input the standard unit and view your converted value.
4. Press [Reset] to clear the current input field and locate the cursor in the input field.
5. To exit length conversion function, press [Back] key.

7.8.4 Weight

1. Select Weight menu.
2. Select desired unit to convert using [Unit].
3. Input standard unit and view converted value.
4. Press [Reset] to clear the current input Field, and locate the cursor in the input field.
5. To exit Mass conversion function, press [Back] key.

7.8.5 Temperature

1. Select Temperature menu.
2. Position the cursor in desired unit by using up or down arrow key.
3. Input standard unit and view converted value.
4. Press [Reset] to clear the current input field and locate the cursor in the input field.
5. To exit Temperature conversion function, press [Back] key.

7.8.6 Volume

1. Select Volume menu.
2. Select desired unit to convert using [Unit].
3. Input standard unit and view converted value.

4. Press [Reset] to clear the current input field and locate the cursor in the input field.
5. To exit volume conversion function, press [Back] key.

7.8.7 Velocity

1. Select Velocity menu.
2. Select desired unit to convert using [Unit].
3. Input standard unit and view converted value.
4. Press [Reset] to clear the current input field and locate the cursor in the input field.
5. To exit Velocity conversion function, press [Back] key.

7.9 World time

The World time function provides time information of major cities worldwide.

1. Press [Menu].
2. Select Useful functions.
3. Select world time.
4. You can view the time of desired country or city using the left and right key.

5. You can select a desired city as a base using [Home].
6. The home city selected in world time is the base for daylight saving calculation for time.

7.* Stop watch

1. Select Stopwatch menu.
2. Press [Go] to start the stopwatch.
3. Press [Stop] to stop the stopwatch and view the measured duration of time.
4. Press [Go] to resume the stopwatch.
5. Press [Lap] during operation to record the duration of time at the moment, and continue the stopwatch.
6. Users can save up to 20 time records by pressing [Lap]. If the number of recorded time exceeds 20, the oldest one is deleted.
7. Press Details to see recorded Lap timings. Press [Reset] to initialise the stopwatch.

8.1 Take photo

1. Select Take photo or press the numeric key (#1) from the Camera menu.
2. Environment Setting.
 - Select the [Options] key.
 - **Size:** Select 'Size' and choose one from 1280x1024, 640x480, 320x240, wallpaper size and Phonebook size.
 - **Quality:** You can select the desired quality of photo by selecting either super fine, fine or normal.
 - **Flash:** Select either Auto(around brightness), Always on(always use flash), When taking(only when taking a photo) or Off(do not use flash).
 - **Multishot:** You can take 3/6/9 photos consecutively (Multishot is available in case of 320x240 size).
 - **Zoom:** You can select zoom level according to the photo size and preview size, and the range of zoom level is 1 to 10. For photos with 1280x1024, only zoom level 1(1:1) is supported.
 - **Brightness:** You can select a level from -2.0 to 2.0 with step size 0.5. The higher the level, the more brighter the screen.

- **White balance:** Using this function you can adjust the tone of the background photo according to the weather by selecting either Auto, Daylight, Cloudy, Shade or Fluorescent.
- **Night mode:** You can take better photos at night.
- **Frame shot:** You can apply 10 kinds of frame effects when taking a picture.(Frame shot is available in case of wallpaper size)
- **Delay timer:** Using this function you can delay the camera shutter time by selecting either Off, 3 seconds, 5 seconds or 10 seconds.
- **Effect:** Using this menu you can select special camera effect by selecting either Off, Black & White, Negative, Sepia.
- **Shutter sound:** You can select the camera shutter sound by selecting either No sound, Sound 1 or Sound 2.
- **Storage:** You can store a photo taken in the internal (Phone) flash memory or the external flash memory.

3. Taking a photo

- Adjust the camera position so that object is in the centre of the screen, and then press the Take key to take a photo of the object. A taken photo saved in the internal (phone)flash memory or the external flash memory. To view existing taken photos, select  soft menu. Then the Photo album is launched, and displays existing photos as thumbnails. Move to a desired photo to view, and select [View] to view the photo. You can also send a selected photo to the other party through the MMS or E-mail (Bluetooth) service by pressing the Send key in the thumbnail list screen.

Summary)

[Take a Picture] → Press the Take key.

[Options] → Size → Select 1280*1024, 640*480, 320*240, Wallpaper size and Phonebook size.

[] → View photos taken.

8.2 Take video

1. This function is selected when you select 2. Take video from the Camera menu.
2. Environment Settings.

- Press the [Options] key.
- **Quality:** You can select the desired quality of video by selecting either Super fine, Fine or Normal (just as you can in Camera).
- **Flash:** Select either Always on (always use flash), When recording (only when recording a video) and Off (do not use flash).
- **Zoom:** Same as Take photo.
- **Brightness:** Same as Take photo.
- **White balance:** Same as Take photo.
- **Night mode:** Same as Take photo.
- **Effect:** Same as Take photo.
- **Recording time:** You can select recording times of 30 seconds, 1 minute, 2 minutes, 5 minutes, 1 hour.
- **Storage:** You can store a photo taken in the internal (Phone) flash memory or the external flash memory.

3. Recording a video

Put the camcorder where you want it and press the "Rec." key to start recording. Press the "Stop" key again to stop recording.

The recorded video is saved in the gallery. To view the recorded video, select [], select a desired video thumbnail from the video list and press “Play”.

Summary)

[Record] → “Rec.” button.

[] → View videos recorded.

8.3 Memory status

8.3.1 Common memory

This function shows the status of the user memory of the mobile phone. Since this function scans the overall file system for statistics, a few seconds are required.

8.3.2 External memory

This function shows the status of the External card user memory. This function displays the In-use and free memory usage statistics.

9. Settings

9.1 Profiles (for SAT SIM)

In case a SAT capable SIM card is in use Profiles is listed here and should provide the same features as described in chapter Profiles on pages 31-32.

9.2 Date & Time

Although the current time is automatically configured when the phone is registered to the network, users can configure time and date directly using 'Time & Date' menu. The time configured by user is valid only while the phone is turned on.

9.2.1 Time

Scroll down to select the hour indicator format i.e. Off, Cuckoo clock or Chime bell.

1. Select the 'Time' item from the Time & Date list, and then press [OK] [Select].
2. Move to your desired field, 'Hour', 'Minute', or 'AM'/'PM' field using the navigation keys.
3. Input 'Hour', and 'Minutes' using the number keys.
4. Select time format using Left and Right navigation keys.

5. Press the Done key to set the time with the specified value.

9.2.2 Date

1. Select 'Date' item from the Time & Date list, and then press [OK] [Select].
2. Select date format using Left and Right navigation keys.
3. Input 'Day', 'Month' and 'Year' using the number keys.
4. Press [OK] [Confirm] to set the date with the specified value.

9.2.3 Daylight saving

Configuring Daylight saving to On Applies daylight saving. If the home city does not support daylight saving, Daylight saving can not be set to **On**.

9.3 Favourites

Favourites allows you to add your own favourites to the list already provided. Once you create your own menu, you can access the desired function quickly in the idle screen by pressing the up navigation key. To move to your desired menu directly, select your

desired menu from the Favourites menu press the up and down navigation keys.

- **Add new:** In the [Empty] list, press the left soft key [Add]. Select the item from the menu and save the desired menu item.
- **Edit:** In the added menu items list, press the left soft key [Options]. Select Edit from the menu to edit a saved menu item.
- **Delete:** In the added menu items list, press the left soft key [Options]. Select Delete from the menu to delete a saved menu item.
- **Delete all:** In the added menu items, press the left soft key [Options]. Select Delete all from the menu item.
- **View infomation:** In the added menu item list, press the left soft key [Options]. Select View infomation from the menu to view the information about the actual location of the added menu item.

9.4 Phone settings

9.4.1 Language

Automatic, English, German, Dutch, Czech, Hungarian, Polish, Croatian, Slovakian.

9.4.2 Display

In this menu, you can configure screen display options including LCD settings and theme.

9.4.2.1 Wallpaper

You can configure the Main LCD background by theme selection.

9.4.2.1.1 Main display

You can select an Main display background to display in idle mode. You can also select the clock and calendar type to appear in idle mode. You can also configure the font size and colour of the clock displayed on the Main LCD idle screen.

9.4.2.1.2 Front display

You can select an Front display background to display in idle mode.

9.4.2.2 Dialling font

When number keys are pressed for call connection in idle state, the size and colour of displayed number can be configured.

9.4.2.3 Colour theme

You can choose the themes between (T-Mobile, Metal, Sky, Orange).

9.4.2.4 Backlight

It allows the user to configure the backlight duration settings for Main LCD, Front LCD and Keypad. Default settings:

- Main LCD duration 10 seconds.
- Front LCD duration 10 seconds.
- Keypad backlight duration 10 seconds.

9.5 Call settings

9.5.1 Call divert

Call divert menus for video, voice, data and fax calls are provided.

However, available menus are determined by the SIM supporting CPHS.

The menu consists of Video calls, Voice calls, Fax calls and Data calls.

The Video menu provides menus to divert video calls and the Voice menu provides menus to divert voice

calls. The Video and Voice menus have the following submenus.

If you select Video calls, the All video calls, If busy, If no answer and If unreachable list appears.

If you select Voice calls, the All voice calls, If busy, If no answer and If unreachable list appears.

9.5.1.1 Video calls

9.5.1.1.1 All video calls

1. When the off menu is selected – Deletes Call Divert Number registered to the network. While waiting for the result from the network, Requesting message and animation appears. When the network answers, the result of the operation is displayed.
2. When the To voicemail centre is selected, it activates or deactivates a Voicemail centre number. To register the VMS number, select Messages? Settings? Voice mail centre from the menu. If you select this menu when there is no registered number, the “VMB not activated” message appears. Selecting this menu when there is a registered number displays Requesting message and animation. When the network answers, the result of the operation is displayed.

3. When To other number is selected – A dialogue window appears allowing you to enter a phone number to divert to. Input a phone number to divert calls to, and press OK button. While waiting the result from the network, Requesting message and animation appears. When the network answers, the result of the operation is displayed.
4. When Input dial number (DN) is selected – A menu appears, a user selects To other number, and inputs a number. Divert registration is performed with the selected number. Select the number, and press the OK button. While waiting for the result from the network, a Requesting message and animation appears. When the network answers, the result of the operation is displayed.
5. Options menu – After activating the All video calls menu, selecting the Options menu at the bottom of the menus displays the Activate, Deactivate, Deactivate all, View status and clear list menus. Activate: Move to Settings menu (above1~4) to activate call divert. The View status menu shows the settings on the network. If you select this menu, Requesting.. message and animation appear. Then the network settings are displayed when the information is received from the network. Selecting

Status in the right soft menu gives the same result. If you select the Deactivate menu, the call divert numbers registered in the network are deleted after user confirmation. Selecting the Cancel all menu will display the operation result after showing the Requesting message and animation. Clear list menu will delete all divert number list.

9.5.1.1.2 If busy

1. When the off menu is selected – It operates the same to All voice calls menu.
2. When To voice mail centre is selected – It operates the same to All voice calls menu.
3. To other number is selected – It operates the same to All voice calls menu.
4. When input dial number (DN) is selected – It operates the same to All voice calls menu.
5. When Options menu is selected – It activates and operates If busy menu. It operates the same to All voice calls menu.

9.5.1.1.3 If no answer

1. When the off menu is selected – It operates the same as All voice calls menu.

2. When To voice mail centre is selected – It operates the same as to All voice calls menu.
3. When To other number is selected – It operates the same as to All voice calls menu.
4. When input dial number (DN) is selected – It operates the same to All voice calls menu.
5. When Options menu is selected – Activates and operates If no reply menu. It operates the same to All voice calls menu except that users can configure delay time in the Set delay menu in the menu list.

9.5.1.1.4 If unreachable

1. When off menu is selected – It operates the same to All voice calls menu.
2. When To voice mail centre is selected – It operates the same to All voice calls menu.
3. When To other number is selected – It operates the same to All voice calls menu.
4. When input dial number (DN) is selected – It operates the same to All voice calls menu.
5. When Options menu is selected – Activates and operates If out of reach menu. It operates the same to All voice calls menu.

9.5.1.2 Voice calls

9.5.1.2.1 All voice calls

1. When the off menu is selected – Deletes Call Divert Number registered to the network. While waiting for the result from the network, Requesting message and animation appears. When the network answers, the result of the operation is displayed.
2. When the To voicemail centre is selected, it activates or deactivates a Voicemail centre number. To register the VMS number, select Messages? Settings? Voice mail centre from the menu. If you select this menu when there is no registered number, the “VMS not activated” message appears. Selecting this menu when there is a registered number displays Requesting message and animation. When the network answers, the result of the operation is displayed.
3. When To other number is selected – A dialogue window appears allowing you to enter a phone number to divert to. Input a phone number to divert calls to, and press OK button. While waiting the result from the network, Requesting message and animation appears. When the network answers, the result of the operation is displayed.

4. When Input dial number (DN) is selected – A menu appears, a user selects To other number, and inputs a number. Divert registration is performed with the selected number. Select the number, and press the OK button. While waiting for the result from the network, a Requesting message and animation appears. When the network answers, the result of the operation is displayed.

5. After activating All video calls menu, selecting the Options menu at the bottom of the menus displays the Activate, Deactivate, Cancel all, View status and clear list menus.

Activate: Move to Settings menu to activate call divert.

The View status menu shows the settings on the network. If you select this menu, Requesting message and animation appear. Then the network settings are displayed when the information is received from the network. Selecting Status in the right soft menu gives the same result. If you select the Deactivate menu, the call divert numbers registered in the network are deleted after user confirmation. Selecting the Cancel all menu will display the operation result after showing the Requesting message and animation. Clear list menu will delete all divert number list.

9.5.1.3 Fax calls

9.5.1.4 Data calls

9.5.2 Call waiting

This menu consists of All Calls Voice call, Video call.

If you select one, activate/deactivate/view status menu list appears.

- 1. Activate:** Activates waiting service. Selecting this item, displays requesting message and animation. When the network answers, the result of the operation is displayed.
- 2. Deactivate:** Deactivates Call waiting service. Selecting this item displays requesting message and animation. When the network answers, the result of the operation is displayed.
- 3. View status:** Displays activated Call waiting service group item of the network. Selecting this item displays requesting message and animation. When the network answers, the result of the operation is displayed.

9.5.3 Call reject

Automatic menu: Users can configure to reject all or a specific number calls by selecting Deactivate, Reject on list, or Reject all calls menu. Selecting Deactivate disables Automatic call reject. Selecting Reject on list rejects only reject target numbers saved in Phone book. Selecting Reject all calls rejects all arriving calls unconditionally by silent or disconnecting. When you configuring Reject on list mode, you can add number to reject by using 'List' menu. When you adding a number to the list, you can select either 'Silent', or 'Disconnect'. You can input number directly or by searching Contacts using 'Search' key.

Manual menu: When On is selected, press and hold the side key for a while to reject a call by silence, and press and hold the side key for a while once again to reject a call by disconnecting. When Off is selected, side key does not work for call reject operation.

9.5.4 Call costs

1. This function displays your call cost of the Last call and All calls.
2. To initialise, press 'Clear' button, and input PIN code.

3. Select Cost Setting to configure call cost settings and call cost limit.
4. You can select either Unit or Currency in call cost settings. According to your setting, call cost is displayed when a call is terminated.
5. In the call cost limit configuration, select On to configure the cost limit. When cost limit is configured, and call cost reaches the limit, making a call will not be allowed.

9.5.5 Video call

1. **Hide my picture:** Option to determine whether to send my picture during VT.
 - **On:** Do not send my picture.
 - **Off:** Send my picture.
2. **Substitute picture:** Option to determine a video to send during VT.
 - **On:** Send substitute video instead of my picture.
 - **Off:** Send my picture.
3. **Substitute picture file:** Option to select substitute video to send instead of my picture during VT.

9.5.6 Send my number

- 1. Set by network:** Configures with the default settings determined by the service provider.
- 2. On:** Configures to send my phone number when making an outgoing call.
- 3. Off:** Configures not to send my phone number when making an outgoing call.

9.5.7 Auto redial

Allows you to set the auto redial function when a call attempt has failed.

9.5.8 Answer mode

Allows you to set the answering method. You can choose between opening the folder, pressing the Send key, and pressing any key.

9.5.9 Minute reminder

Determines whether to sound a 1 minute tone every 1 minute when you are on the phone.

9.5.* Closed user group

9.6 Connectivity

9.6.1 Bluetooth

Bluetooth Connection

- **Menu** → **9. Settings** → **6. Connectivity** → **1. Bluetooth**

Your phone has built-in Bluetooth wireless technology which makes it possible for you to connect your phone wirelessly to other Bluetooth devices such as a handsfree, PC, PDA, a remote screen, or other phones.

You can, for example, have a conversation via a cordless Bluetooth handsfree or browse the Internet, wirelessly connected via a mobile phone.

You can also exchange, for example, business cards, calendar items and pictures.

Note

We recommend that your phone and the Bluetooth device you are communicating with be within a range of 10 meters. The connection may be improved if there are no solid objects in between your phone and the other Bluetooth device.

1. Getting Started

- **Menu** → **9. Settings** → **6. Connectivity** → **1. Bluetooth** → **1. Paired devices**

To use the Bluetooth function, you must first set Bluetooth to "On". Complete the above procedures to set Bluetooth to "On".

2. Configuring Bluetooth Settings

- **Menu** → **9. Settings** → **6. Connectivity** → **1. Bluetooth** → **2. Settings**

- **Bluetooth:** To use the Bluetooth function, set it to [On]. Otherwise, set it to [Off].
- **Audio device:** You can set [Audio device] to [Headset] or [Handsfree].
- **My handset' s visibility:** Set [My handset' s visibility status] to [Shown to all] so that other devices can detect your phone when they are searching for a Bluetooth device. If you select [Hidden], other devices will not be able to detect your phone when they are searching for a Bluetooth device.
- **My handset' s name:** You can name or rename your phone as it will appear on other devices.

Your phone's name will be shown on other devices only when [My handset' s visibility] is set to [Shown to All].

- **Passcode request:** You can choose for your phone to ask for your password when another Bluetooth device is trying to connect to it. If this option is set to "Off", you can immediately connect to another Bluetooth device without entering your password.
- **BD address:** The BD address is set when your phone is sold. You cannot change the BD address.

3. Paired Device

Pairing Devices(Pairing with a device)

If a paired Bluetooth device already exists,

- **Menu** → **9. Settings** → **6. Connectivity** → **1. Bluetooth** → **1. Paired devices** → **Options** → **Add new**

If there is no paired Bluetooth device,

- **Menu** → **9. Settings** → **6. Connectivity** → **1. Bluetooth** → **1. Paired devices** → **Add**

Options

- 1. Add new:** Using this menu, you can pair a new Bluetooth device with your phone.

2. Connect: Using this menu, you can connect an audio device.

A. This item is only enabled in the Option menu when you have selected Audio device. If another device has been selected, this item is disabled.

B. Move to [Connect] and select [OK]. Your phone is immediately connected to the audio device.

3. View Detail: Using this menu, you can view information about the paired device.

4. Set as authorised: Using this menu, you can choose to receive alerts when data arrives from another device.(Set as authorised <-> Set an unauthorised)

5. Assign short name: Using this menu, you can rename a paired phone as required.

6. Delete: Using this menu, you can delete the paired Bluetooth device.

7. Delete all: Using this menu, you can delete all of the paired Bluetooth devices.

- To search for a Bluetooth device to connect, press the above key.
- Screen shows "Searching for Device" .

Bluetooth devices within a range of 10m will be found.

- If Bluetooth devices are found, these devices are listed on the screen. If no Bluetooth device is found, you will be asked if you want to search again.

- If you select a device from the listed devices, the device information (name, address, service class) will appear on the screen.

- Pairing procedure

- Press the Bond key. A window will appear on the screen asking you to enter your password.
- After creating a password (of 1 to 16 digits), the user of the other device must enter the password for pairing. The user of the other device must know the password in advance for authentication.
- If the other party authenticates the connection, the Paired device list is displayed on the screen and you can use your phone to communicate with the other device.

<Disconnecting Devices>

1. Select a device to disconnect from the Paired devices screen.
2. You can disconnect a device by pressing the Delete key or by selecting Options → Delete. To disconnect all paired devices, select Options . Delete All.

<Transmitting Data Using Bluetooth>

1. To transmit data from your phone to another Bluetooth device, first select the application where the target data is saved. For example, to send data in the Media album to another device, select
 - Menu → 2. My Media → 1.Photos → Select data to transmit → Send via → 3. Bluetooth
2. Transmitting Data
 - If a paired Bluetooth device exists,
 - 1) Select the desired device from the paired devices listed on the screen.
 - 2) If the other party selects [Yes] for [Bluetooth Authorisation required], the data is transmitted.
 - If there is no paired Bluetooth device,
 - 1) Select Search to search for nearby Bluetooth devices to connect.

- 2) Select the device to which you want to transmit data from the devices on the screen and press the Push key.
- 3) The other party will specify a password.
- 4) You must know the password specified by the other party.
- 5) If the other party selects [Yes] for [Bluetooth Authorisation required], the data is transmitted.

<Receiving Data using Bluetooth>

Menu → 9. Settings → 6. Connectivity → 1. Bluetooth → 1. Paired devices

1. If you enable Bluetooth function as described above, you can connect your phone to other Bluetooth devices.
2. If another party attempts to transmit data, the [Bluetooth Authorisation required] question will appear on the screen. If you select [Yes], the data will be transmitted to your phone. During data transmission, the Bluetooth icon flashes.

<Bluetooth Data Storage Folder>

You can check the received data by selecting Menu → 2. My Media → 7. Bluetooth data.

4. Device

<Connecting a Headset>

1. Select Menu → 9. Settings → 6. Connectivity → 1. Bluetooth → 2. Settings and check that [Audio Device Select] is set to [Headset]. (If Bluetooth is disabled, enable Bluetooth.)
2. Connect the headset according to the procedures described in the Pairing Devices section.
3. To use the headset, select the headset from the registered devices, press the Option key and then select 2. Connect.
4. To check that the selected headset has been connected successfully, press the Option key. If it is properly connected, 2. Disconnect will appear. If it is not connected, 2. Connect will appear.

<Connecting a Handsfree Kit>

1. Menu → 9. Settings → 6. Connectivity → 1. Bluetooth → 2. Settings and check that [Audio Device Select] is set to [Handsfree]. (If Bluetooth is disabled, enable Bluetooth.)
2. Connect the handsfree kit according to the procedures described in the Pairing Devices section.

3. To use the handsfree kit, select the handsfree kit from the registered devices, press the Option key and then select 2. Connect.
4. To check that the selected handsfree kit has been connected successfully, press the Option key. If it is properly connected, 2. Disconnect will appear. If it is not connected, 2. Connect will appear.

9.6.2 Network settings

9.6.2.1 Network selection

1. You can select either Automatic or Manual network selection.
2. If you select Automatic, connection continues according to the Automatic network selection procedures. This setting is recommended for best service and quality.
3. If you select Manual, all the currently 2G (GSM) and 3G (UMTS) available networks are shown, and you can select one of them for registration. If the registration of the network has failed, then all the currently available networks are listed again, and you can select any other one for registration.

9.6.2.2 Preferred lists

1. Select Preferred lists to display the preferred list saved in the current SIM card.
2. You can edit and save a preferred list in the SIM card by selecting the menu when the preferred list is displayed.
 - **Add**
 - **Delete**
 - **Options:** (Add new, Search/Enter new network Delete)

9.6.2.3 GPRS

1. If you set GPRS option to "Power on", the registration process for GPRS service is started when power on. In this case, other registration process is not need for GPRS service.
2. If you set GPRS option to "when needed", the registration process for GPRS service will be started only when an application requires GPRS service.

9.6.2.4. System mode

1. If you set to Dual mode, then both 3G (UMTS) and 2G (GSM) services can be used. This setting is recommended for best service and quality.
2. If you set to GSM only, then only 2G (GSM) service can be used.

9.6.3 Access points

Access points

This menu shows the access point list. You can create new profiles, delete or edit them by using the Option Menu. However, you cannot delete or edit default configurations.

You can edit the following configuration items by selecting the right soft key.

Connection title	Access Point profile name.
Bearer	Choose the bearer from the list. (Default is "UMTS/GPRS")
Authentication	Choose the authentication from the list. (Default is "No auth")
Username	Information provided by Service Provider.
Password	Information provided by Service Provider.

APN	APN name to access network. Information provided by Service Provider.
Traffic Class	Choose the Traffic Class from the list. (Default is "Subscribed")
Req. Max UL Bitrate	Choose the Maximum Uplink Bitrate from the list. (Default is "Subscribed")
Req. Max DL Bitrate	Choose the Maximum Downlink Bitrate from the list. (Default is "Subscribed")
Dial-up number	Required in case of Bearer is "UMTS/GPRS/CSD" or "CSD" Information provided by Service Provider.
Baud rate	Required in case of Bearer is "UMTS/GPRS/CSD" or "CSD" Choose the value from select list. (Default is "9600")
Call type	Required in case of Bearer is "UMTS/GPRS/CSD" or "CSD" Choose Call type from the list. (Default is "ISDN")
CSD Password	Required in case of Bearer is "UMTS/GPRS/CSD" or "CSD" Information provided by Service Provider.
CSD Username	Required in case of Bearer is "UMTS/GPRS/CSD" or "CSD" Information provided by Service Provider.

- Press "Done" key to save any configuration changes.

9.6.4 Sync Service

If Sync service is supported by your network operator, that service function synchronizes the data in a phone and the data on a server such as contact address information and schedule items via a wireless network.

9.6.4.1 Connect

• **Menu** → **Settings** → **Connectivity** → **Sync service**

1. Select the Connect item and then press the Select key.
2. Connect to the server with the selected server profile and the synchronization animation is displayed while the synchronization is performed.

9.6.4.2 Logs

• **Menu** → **Settings** → **Connectivity** → **Sync service**

Select the Log item and then press the Select key to view the log for the last synchronization operation performed.

9.6.4.3 Sync types

• **Menu** → **Settings** → **Connectivity** → **Sync service**

Select the Sync Types item and then press the Select key to view the synchronization types.

A. Normal

The phone and the server are required to exchange information about the modified data.

B. Backup

The phone sends all its data from a database to the server. The server is expected to replace all data in the target database with the data sent by the phone. This means that the phone overwrites all data in the server database.

9.6.4.4 Settings

• **Menu** → **Settings** → **Connectivity** → **Sync service**

1. Select the Settings item and then press the Select key.
2. This menu allows you to configure the profile for a synchronization server.

9.6.5 Dialup network

The Dialup network function synchronizes the data in a phone and the data on a server such as contact address information and schedule items via a wireless network.

9.6.6 Streaming

This menu shows the Streaming settings and you can set it.

9.7 Security

You can activate a PIN code. When it is activated, a window asking you to enter the PIN code appears when you turn on the phone so as to prevent unauthorized use of the phone.

9.7.1 Handset lock

You can lock your mobile phone to prevent it being used by other people. The following 4 lock functions are provided.

- **Power On:** Whenever the mobile phone is turned on.
- **If SIM Changed:** When the mobile phone's SIM card has been changed.
- **Immediate:** Locks the phone immediately.
- **Off:** Cancels lock function.

9.7.2 PIN code request

You can activate a PIN (Personal Identification Number). You can check the current status of configuration from the status bar.

PIN request and release procedures

Item	Description
Enable PIN Request	You have to input the PIN code each time the mobile phone is turned on.
Disable PIN Request	You do not have to input the PIN code when the mobile phone is turned on.

1. Select 'PIN Code Request' item from the list, and press [Select]. Then a window allowing you to select 'On' or 'Off' appears.
 - Select 'On'/'Off' from the list, press [Select], and input the current PIN code to set the PIN request. If 'PIN Code Request' is already enabled/disabled, an "Already activated"/ "Already cancelled" message will be displayed.
2. 3 incorrect PIN code entries in the PIN code input window would invalidate the PIN code. In this case, you have to input the PUK (PIN Unblock Key) code to configure the PIN code again.

3. The maximum allowed number of attempts of PUK input is 10 times. **ATTENTION:** after having entered 10 times an incorrect PUK code, the SIM card will be blocked and must be replaced.

Press the C key in the PIN code input window to return to the previous step.

9.7.3 Call barring

Call barring menus for All calls, Video, Voice are provided.

However, available menus are determined by the SIM supporting CPHS.

The menu consists of All calls, Video, Voice.

The All calls menu provides menus to barring all calls and the Video menu provides menus to barring video calls. the Voice menu provides menus to barring voice calls. The All call, Video and Voice menus have the following submenus.

If you select All calls, Outgoing calls, International calls, International except home country, Incoming calls, and Incoming calls when abroad submenus. menu list appears.

The Call barring menu consists of Outgoing calls, International calls, International except home country, Incoming calls, and Incoming calls when abroad submenus. However, the menus available depend on whether the SIM supports CPHS. The Outgoing calls menu bars dialing outgoing calls, the International calls menu bars dialing outgoing international calls, the International except home country menu bars dialing outgoing international calls except for the Home PLMN country, Incoming calls rejects incoming calls, and the Incoming calls when abroad menu rejects incoming calls in roaming.

9.7.3.1 All calls

9.7.3.2 Video calls

9.7.3.3 Voice calls

All outgoing

1. When OK button is selected – Receives Barring password from user, and activates barring service on the network. Requesting message and animation appears. When the network answers, the result of the operation is displayed.

2. When Options menu is selected – It activates Outgoing calls menu. Select options menu from the soft menus on the lowest menu. Then, Activate, Deactivate, Deactivate all, View status, and Barring password menu appear. Select Activate menu to receive Barring Password from user and activates the barring service on the network. Deactivate menu deactivates barring service after Barring Password input of user. Deactivate all menu deactivates all barring service configured in the network after Barring Password input of user. View status menu enables users to view the current network configuration. Selecting View status menu displays Requesting message with animation and the result of the operation when the network answers. Barring password menu enables users to change current barring password.

Outgoing international

1. When OK button is selected . It operates the same to Outgoing calls menu.
2. When Options menu is selected – It activates and operates International calls menu. It operates the same to Outgoing calls menu.

Outgoing international calls except home country

1. When OK button is selected It operates the same to Outgoing calls menu.
2. When Options menu is selected – It activates and operates International except home country menu. It operates the same to Outgoing calls menu.

All incoming

1. OK button select It operates the same to Outgoing calls menu.
2. When Options menu is selected – It activates and operates Incoming calls menu. It operates the same to Outgoing calls menu.

Incoming calls when roaming

1. OK button select. It operates the same to Outgoing calls menu.
2. When Options menu is selected – It activates and operates Incoming calls when abroad menu. It operates the same to Outgoing calls menu.

9.7.4 Fixed dial number

1. To enter the menu allowing FDN configuration, PIN authentication is required.

2. The first menu displays the current configured number. Enter configuration menu through Option menu.
3. For configuration, input name and phone number. The configuration information is saved in SIM.
4. The information saved in SIM is used when FDN restricts outgoing calls.

9.7.5 Change password

You can change PIN, PIN2, the mobile phone password and the call barring password.

9.7.5.1 PIN code

PIN is the abbreviation of Personal Identification Number, and is used to restrict the use of an unauthenticated user.

PIN code Change Procedure

1. Select 'PIN code' from the 'Change password' list and then press [OK].
2. Input the current PIN code, and press [OK].
3. Input the new PIN code, and press [OK].
4. Input the new PIN code once again, and press [OK].

- If the PIN code is different from that of step 3, the procedure is restarted from step 3.
 - 5. When the PIN code is properly changed, a "PIN changed" message is displayed. With an incorrect PIN code input in step 2, the procedure is restarted from step 2, and the remaining allowed number of input attempts is decreased by 1.
 - 6. Press the C key in the PIN code input window to return to the previous step.
- * 3 incorrect PIN code entries in the PIN code input window would invalidate the PIN code. In this case, you have to input the PUK (PIN Unblock Key) code to configure the PIN code again. The maximum allowed number of attempts of PUK code input is 10 times. ATTENTION: after having entered 10 times an incorrect PUK code, the SIM card will be blocked and must be replaced.

9.7.5.2 PIN2 code

PIN2 is the abbreviation of Personal Identification Number 2, and is used to restrict the use of unauthenticated users like PIN. The PIN2 code change procedure is the same as the one for the PIN code. 3 incorrect PIN2 code entries would invalidate the PIN2 code. In this case, you have to input the PUK2

code in order to use the PIN2 code again. The maximum allowed number of attempts of PUK2 code input is 10 times, like PUK1. 10 incorrect PUK2 code entries would invalidate the PIN2 code.

9.7.5.3 Security code

The security code is used to change the mobile phone password. The maximum allowed number of attempts of security code input is not limited like PIN and PIN2.

9.8 Memory status

This function shows the usage of the memory of the mobile phone that can be used to save user data. User data is saved in a FLASH memory, a type of non-volatile memory, keeping saved data permanently unless the data are deleted by user.

9.8.1 Common memory

This function shows the status of the common memory. The function takes few seconds to load the contents. The usual contents are related to Audio, Video, Multimedia, Java etc. It gives the size in terms of Kilobytes for each item in the common memory.

9.8.2 Reserved memory

This functions shows the status of the reserved memory. The usual contents are Text messages, Contacts, Calendar To Do, Memo and Secret memo. It give a clear illustration of the actual number to the total number of count of each item.

9.8.3 SIM memory

This function shows the status of the SIM card user memory.

9.8.4 External memory

This function shows the status of the External card user memory. This function displays the In-use and free memory usage statistics.

9.9 Handset info.

This functions shows the SIM card telephone number, model name and software version of the mobile phone.

9.* Internet

How to Connect to Internet (Internet Settings)

1. Setup (Default)

- User can connect to Internet using one of the settings values configured in Internet "Settings" menu's Accounts list.
- The list of setting values can be seen by selecting "Setting" menu's "Accounts" sub menu.
- An item with check icon on the right side of the list is default item.
- Users can add or edit settings other than "T-Mobile Internet" that is default connection setting.
- To change the default connection settings, select one of the items listed in the settings menu and press "OK". The selected item will be displayed with check icon "✓" on right hand side of the selected list.
- Changing default profile may result in services no longer working.

2. Additional Setup

- Select “Settings” menu’ from “Internet ” menu”, Select next menu “Accounts”. Open “Options” menu by pressing Left Soft Key and select “Add” option.

The following items need to be configured

Account title	Settings account name. (e.g. T-Mobile WAP)
Homepage	Service URL. (e.g. www.t-zones.co.uk)
Connection Mode	Choose from given list of connection modes. (default is UDP (CO))
Proxy IP	WAP Gateway IP address provided by the operator. (e.g. 193.254.160.002)
Proxy Port	Port details are provided by operator, depending upon “Connection Mode”.
Security	Choose “secure” connection if needed, Default value is “Non-Secure”.
Timeout	Linger time setting. (150 seconds as a default)
Access Point	Access point setting for the corresponding service. (More details for adding or editing new Access Point refer step 3)

- Press “Done” key to save any configuration changes.

3. Access Points

- User can list the available Access Points by selecting “List” appears on Centre soft menu of “Access point” parameter from Internet setting value.
- User can add a new Access Point by selecting “Add New” from “Option” menu.
- Press “Done” key to save any configuration changes.

The details for Access Point parameters are as follows:

Connection title	Access Point profile name.
Bearer	Choose the bearer from the list. (Default is “UMTS/GPRS”)
Authentication	Choose the authentication from the list. (Default is “No auth”)
Username	Information provided by Service Provider.
Password	Information provided by Service Provider.
APN	APN name to access network. Information provided by service provider.
Traffic Class	Choose the Traffic Class from the list. (Default is “Subscribed”)

Req.Max UL Bitrate	Choose the Maximum Uplink Bitrate from the list. (Default is "Subscribed")
Req.Max DL Bitrate	Choose the Maximum Downlink Bitrate from the list. (Default is "Subscribed")
Dial-up number	Required in case of Bearer is "UMTS/GPRS/CSD" or "CSD". Information provided by Service Provider.
Baud rate	Required in case of Bearer is "UMTS/GPRS/CSD" or "CSD" Choose the value from select list. (Default is "9600")
Call type	Required in case of Bearer is "UMTS/GPRS/CSD" or "CSD" Choose Call type from the list. (Default is "ISDN")
CSD Password	Required in case of Bearer is "UMTS/GPRS/CSD" or "CSD" Information provided by Service Provider.
CSD Username	Required in case of Bearer is "UMTS/GPRS/CSD" or "CSD" Information provided by Service Provider.

Browser Menu (Online Menu)

Browser Menu is seen once the page is displayed. On selecting "Menu" from Left Soft Menu of browser, various options are provided and these are as follows:

Back	Returns to the previous page.
Forward	To go to next page, If user navigated to previous pages.
Reload	Reloads the current page.
Home	To access the homepage URL configured in current default setting.
Go to URL	A desired URL can be entered here to visit.
Bookmarks	Adding page displayed as Bookmark and other operations of bookmark.
Settings	Provides a menu for "Character encoding", "Scrolling control", "Show image", "Cache", "Cookie", "Clear cache", "Clear cookie" and "Certificate", "Session info." and "Clear temporary files".

9.*.1 Home

Upon selecting Internet, connection is made to Internet using configured setting information.

9.*.2 Bookmarks

To store the frequently access or favourites URLs/Pages. Add, Edit or delete operations can be performed on bookmark. Few preconfigured URLs are stored as Bookmark.

- To add new bookmarks select "Add" from Right Soft Menu. Enter "Title" and associated "URL" information and press "OK" or "Done" key to save.
 - To connect to desired bookmark select "Connect" from "Options" menu.
 - To edit the existing bookmark select "Edit" from "Options" menu.
- To delete bookmark(s) select "Delete" from "Options" menu.

9.*.3 Saved pages

User can show a internet page to be saved.

9.*.4 Go to URL

9.*.4.1 Enter address

User can edit a URL to directly Connect to the page and connect to a edited URL.

To enter a symbol, press the Asterisk ("*") key to display symbol table and to switch input mode, press the POUND ("#") key.

9.*.4.2 Recent pages

"Recent page" is the recent browsing page. (History)

9.*.5 Security

Show a certification information, if user press the one of Certificates list. And Clear secure session information. If user press the clear session.

9.*.5.1 Certificates

If stored, a list of root/ca certificates required for WTLS/TLS can be found here. Certificates can be viewed or deleted from the list.

9.*.5.2 Clear session

Secure (WTLS/ TLS) session data can be cleared using this option. Session data should be cleared to establish a new secure session.

9.*.6 Settings

9.*.6.1 Accounts

9.*.6.2 Character encoding

Select character set.

9.*.6.3 Scrolling control

Select scroll line.(1~3 line)

9.*.6.4 Show image

Showing image[On] or Not Showing image [Off].

9.*.6.5 Cache

Supporting the “Cache” function [On] or Not Supporting the “Cache” [Off].

9.*.6.6 Cookie

Supporting the “Cookie” function [On] or Not Supporting the “Cookie” [Off].

9.*.6.7 Clear cache

Clear all caches.

9.*.6.8 Clear cookie

Clear all cookies.

9.*.6.9 Clear temporary files

Clear all temporary files.

9. # Reset settings

It resets the handset memory and Default settings brings all the phone settings to its default values.

In Clear memory “Handset Contents” will reset Java, Bookmarks, Saved internet pages, Recent internet pages, Videos and Audios. “Handset personal info” will reset Contacts, Messages, Diary, Alarms, Calls. No SIM memory option. “External memory” will reset the external memory.



Troubleshooting

Please check to see if any problem which you may have with your phone is described here before taking it for service or calling a service engineer.

Q How do I view the list of outgoing calls, incoming calls and missed calls?

A Press .

Q How do I clear all call history?

A Press the left soft key and then   .

Q How do I view all numbers saved in the memory?

A Press the right soft key and then .

Q  does not disappear from the screen.

A Check whether you are in a service area. If you continue to see , turn off the power and wait for approximately 2 minutes before turning it back on. If there is no change, relocate to another area and check again.

Q Connection is poor or is not audible in certain areas.

A In certain areas, signal strength can vary dramatically.
Try moving to a different location. Heavy network traffic may affect the ability to connect, or the stability of the call.

Q Connection is poor even when established.

A In certain areas, signal strength can vary dramatically.
Try moving to a different location. Heavy network traffic may affect the ability to connect, or the stability of the call.

Q LCD does not turn on.

A Remove and replace the battery and turn on the power. If the phone still does not turn on, charge the battery and try again.

- Q** An echo can be heard during connection with a certain telephone in a certain area.
- A** It is called 'Echo Phenomenon'. It occurs if the volume is too high or caused by special properties (semi electronic telephone exchange) of the machine on the other end.
- Q** The phone gets warm.
- A** During long calls, or if games/Internet are used for a long time, the phone may become hot. This is perfectly normal and has no effect upon the life of the product or performance.
- Q** The bell does not ring, or lamp or LCD blinks only.
- A** The phone is set to 'Vibrate' or 'Silent' in the Profiles menu. Please select 'General' or 'Loud'
- Q** Standby duration of the phone gradually becomes shorter.
- A** Batteries have a limited life. When the battery lasts for half its original time, it requires replacement. Only use authorised replacement parts.
- Q** Usage time of battery becomes shorter.
- A** If the battery time is short, it may be due to the user environment, or large volume of calls, or weak signals.
- Q** No number is dialled when you recall a phonebook entry.
- A** Check that the numbers have been saved correctly, by using the phonebook Search feature. Resave them, if necessary.
- Q** You cannot be contacted.
- A** Is your phone switched on ( pressed for more than three seconds)? Are you accessing the right cellular network? Have you set an incoming call barring option?
- Q** I cannot find the lock, PIN, or PUK code, or password?
- A** The default lock code is '0000'. If you forget or lose the lock code, contact your phone dealer. If you forget or lose a PIN or PUK code, or if you have not received such a code, contact your network service provider.

Accessories

There are a variety of accessories available for your mobile phone. You can select these according to your personal communication requirements. Consult your local dealer for availability.

AC Adapter (supplied in basic kit)

This adapter lets you charge the mobile phone while at home or in the office.



Stereo Headset with Remote Control (supplied in basic kit)

Allows hands-free operation. Includes earpiece and microphone.

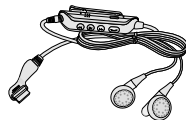

Battery (supplied in basic kit)

Standard battery is available.

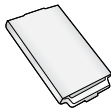

Data Kit (supplied in basic kit)

The Data Kit consists in a USB Data Cable and a CD-ROM, it allows you to connect your phone to a PC.



Cigarette Lighter Adapter

To operate the phone and trickle charge the phone's battery from your vehicle.

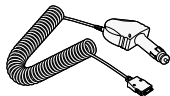

On the CD-Rom, there are programs like:

- PC-Sync: to synchronise phonebook with PC and Outlook.

- Phone Manager: to download wallpapers, ring tones and video clips on the phone.
- Internet Kit: to use the phone as a modem to be connected to a PC.

* When installing, make sure to connect to the PC after your phone and the cable have been connected. Otherwise, your PC may problem.

! Note

The programs listed above may vary depending on the version of the CD and the market.

! Note

- Always use genuine LG accessories. Failure to do this may invalidate your warranty.
- Accessories may be different in different regions; please check with our regional service company or agent for further enquiries.

Index

- A**
- Access Codes 18
 - Access points98, 106
 - Add new 65, 72
 - Alarm clock 74
 - Answer mode 93
- B**
- Backlight 88
 - Barring Password 22
 - Battery12, 16, 112
 - Battery Information9
 - Battery cover 16
 - Browser107
- C**
- Calculator 79
 - Calendar 74
 - Call barring 101
 - Call divert 88
- Camera 16, 17, 83
- Change password 103
- Charging the Battery 12
- D**
- Dialled calls 48, 49
 - Dialling font 87
 - Display Information 20, 21, 22
 - Download 70
- E**
- Entering Text 25
- H**
- Handset 105
 - Handset lock 100
 - Headset 31
- I**
- Inbox 61
- J**
- Java 39, 40
- K**
- Key tone 32
- L**
- Language 87
 - Light 16
- M**
- Mailbox 63
 - M e m o 77
 - Memo Add 77
 - Memory card14, 15, 16
 - Memory status 85, 104
 - Message alert 66
 - Message tone 66
 - Missed calls 48
 - Multimedia 51, 65, 66

N

- Network 97, 100
- Network selection 97

O

- Open flip 24
- Own number 72

P

- PIN code 18, 103
- PIN code request 101
- PIN2 code 18, 104
- Press any key 24
- Profiles 31, 32, 86
- PUK code 18
- PUK2 code 19

R

- Received calls 48, 49
- Roaming 102, 103

S

- Screen 20, 21
- Search 53, 72
- Secret memo 105
- Security 100, 108
- Security code 19, 104
- Signal Strength 25
- SIM 10, 11, 16
- SIM memory 105
- SMTP 69
- Speed dials 72
- Stopwatch 82

T

- Templates 65
- To do 77

U

- Unit Converter 80

V

- Vibrate only 31
- Video call 17, 92
- Video calls 88, 102
- Video player 44
- Voice call 90, 102
- Voice mail 65, 70
- Voice recorder 78
- Volume 16, 81

W

- World time 81

Declaration of Conformity LG Electronics

Suppliers Details

Name

LG Electronics Inc

Address

LG Electronics Inc, LG Twin Towers 20,
Yeouido-dong, Yeongdeungpo-gu, Seoul, Korea 150-721

Product Details

Product Name

E-GSM 900 / DCS 1900 / PCS 1900 / W-CDMA Terminal Equipment

Model Name

UR250

Trade Name

LG

C € 0889

Applicable Standards Details

R&TTE Directive 1999/5/EC

ETSI EN 301 489-01 V1.5.1, ETSI EN 301 489-07 V1.2.1

ETSI EN 301 489-17 V1.2.1, ETSI EN 301 489-24 V1.2.1

ETSI TS 151 010-1 V5.5.0 specified by ETSI EN 301 611 V9.0.2

ETSI TS 134 121 V5.5.0 specified by ETSI EN 301 908-2 V2.2.1

ETSI EN 301 908-1 V2.2.1, ETSI EN 300 328 V1.4.1

EN 50360:2001; EN 50361:2001

EN 60680 : 2001

Supplementary Information

The conformity to above standards is verified by RFI

Declaration

I hereby declare under our sole responsibility
that the product mentioned above to which this
declaration relates complies with the above mentioned
standards and Directives

Name

Jin Seog, Kim / Director

Issued Date

29, July, 2005

LG Electronics Inc, Amsterdam Office
Veluwezoom15, 1327 AE Almere, The Netherlands
Tel : +31 - 36- 547 - 8940, e-mail : seokim @ lge.com

Signature of representative



A series of 20 horizontal dotted lines for writing.

M e m o

A series of horizontal dotted lines for writing.